

Addendum 4

Request for Quotation

MA24- 5035 Interior Door Replacement at Homelands Senior Public School

TO: ALL POTENTIAL BIDDERS

This Addendum 4 has been issued for the above mentioned RFQ for the following:

- Please see attached Addendum No. 4 from Consultant with answered questions from bidders and supplementary information (drawing).

All other terms and conditions shall remain the same.

Regards,

John Marinescu, Commodity Specialist
Peel District School Board
Tel. (905) 890.1010 x 2123
Fax. (905) 890-0660
E-mail: john.marinescu@peelsb.com



**ADDENDUM No. 4
To BID DOCUMENTS FOR
HOMELANDS SENIOR PUBLIC SCHOOL
2420 HOMELANDS DRIVE, MISSISSAUGA, ON
INTERIOR DOOR REPLACEMENT
OHE PROJECT NO. 28769
MAY 2, 2024**

This Addendum consists of one (2) page and one (1) attachment. This Addendum is to make the following clarification and changes to the Bid Documents:

Respondents shall acknowledge receipt of the Addendum by signing below and including the signed copy in the bid submission.

1.1 CLARIFICATIONS

Please note the following clarifications/modifications/additions below in response the Bidders` questions that arise during the Tender site walkthrough on Friday, April 26, 2024 and email received.

1. QUESTION #1:

Can you please confirm whether the painting of the Doors should be shop-finished or on-site? You can allow for on-site painting for existing and new frames, right?

RESPONSE: All new door slabs and frames that are within the scope of the interior door replacement (mentioned to be replaced in door schedule SCH-1) should be shop-finished. The remaining existing door slabs and frames that are not within the scope of interior door replacement (mentioned to be re-painted or not, in the door schedule SCH-1) are to be checked for holes, filled if needed, clean and prepped for repainting on site.

2. QUESTION #2:

During the site walkthrough, I observed that, besides some door locations there are lockers where doors with frames need to be removed and replaced; so are we responsible for removing those and reinstating those lockers as well?

RESPONSE: Any lockers that require removing will have to be re-installed by the Contractor.



CONSULTANTS
Occupational Hygiene & Environment

3. QUESTION #3:

As the Scope of work states that, at a few locations Install additional structural reinforcing components above the ceiling to support new two interior door frames in the hallway; however, we don't have details regarding those, so could you provide the structural details on that?

RESPONSE: Refer to the attached additional (architectural and structural) details Drawing No. SK8.

4. QUESTION #4:

It's specified in the documents that " ALL NEW DOORS AND FRAMES SHOULD BE PAINTED PRIOR TO BE DELIVERED ON SITE". Please confirm if this is what is required as typically painting is done on site.

RESPONSE: Refer to the response of the question no.1.

5. QUESTION #5:

It looks like your table is missing frame painting scope for single doors. We suggest you to change the scope from "without frames" to" including frames" under scope #3, 4 and 5.

RESPONSE: In addition to our response to question no.1, in Statement A – Bid No. I it states "Repaint all frames and slabs in the original building that are not within the scope of replacement".

Attachment:

Additional (architectural and structural) details Drawing No. SK8.

END OF ADDENDUM NO. 4

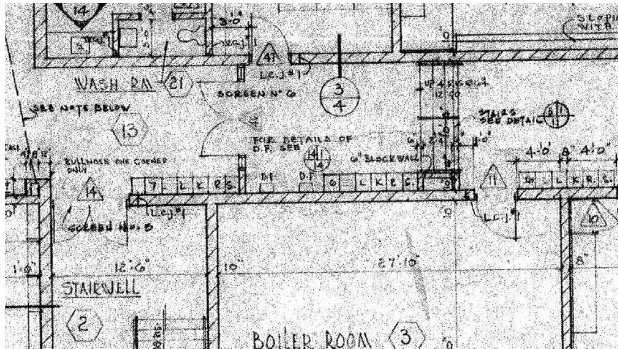

DOOR NO. 30 - HALLWAY - FIRST FLOOR PLAN
N.T.S.
(FROM ORIGINAL ARCHITECTURAL PLANS)

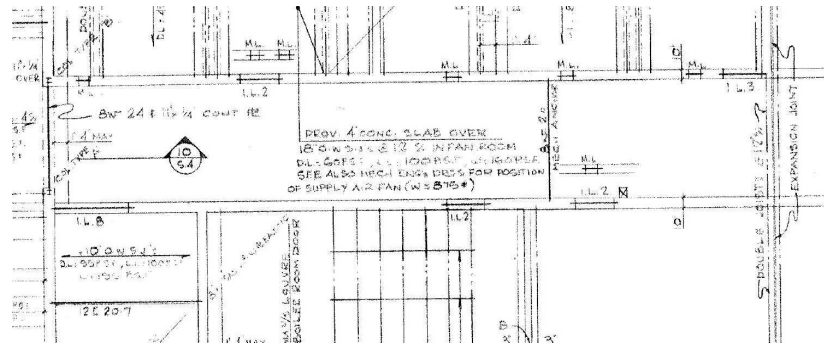

DOOR NO. 30 - SECOND FLOOR FRAMING PLAN
N.T.S.
(FROM ORIGINAL STRUCTURAL PLANS)

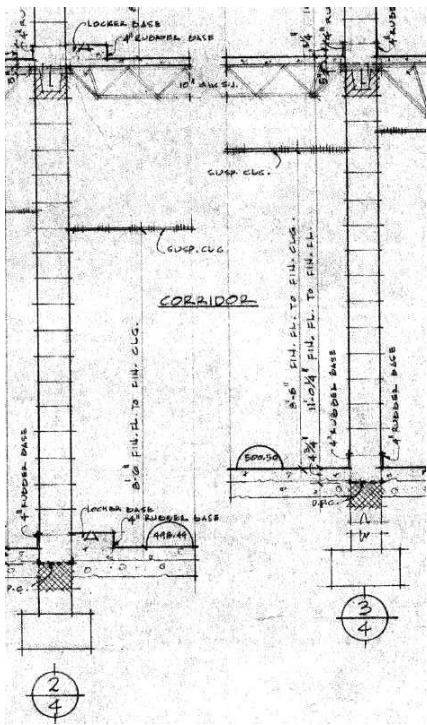

DOOR NO. 30 - HALLWAY - WALL SECTION
N.T.S.
(FROM ORIGINAL ARCHITECTURAL PLANS)

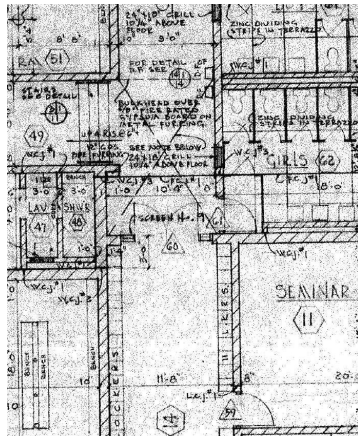

DOOR NO. 40 - HALLWAY - FIRST FLOOR PLAN
N.T.S.
(FROM ORIGINAL ARCHITECTURAL PLANS)

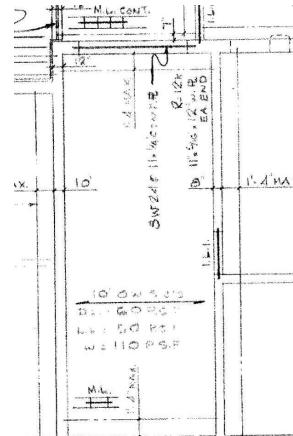

DOOR NO. 40 - SECOND FLOOR FRAMING PLAN
N.T.S.
(FROM ORIGINAL STRUCTURAL PLANS)

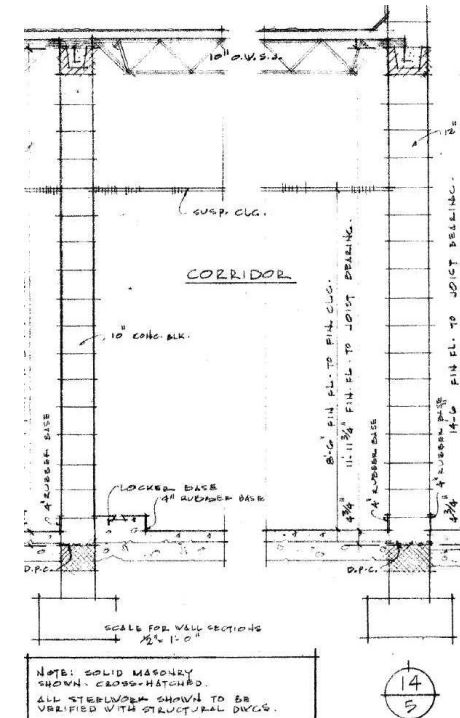

NOTE: SOLID MASONRY SHOWN CROSS-HATCHED. ALL STEELWORK SHOULD TO BE VERIFIED WITH STRUCTURAL DWGS.

DOOR NO. 40 - HALLWAY - WALL SECTION
N.T.S.
(FROM ORIGINAL ARCHITECTURAL PLANS)

REPRINTED FROM ORIGINAL ARCHITECTURAL & STRUCTURAL DRAWINGS BY HANKS, IRWIN & PEARSON ARCHITECTS, DATED NOV. 1967

Note:
Contractor must check and verify all dimensions and job site conditions and report any discrepancies to the appropriate authority prior to commencing construction.

All drawings and specifications and related documents are the copyright properties of the Peel Board of Education.

| DATE | ISSUED FOR |
|-----------|-------------------|
| MAY 2024 | RFQ (ADDENDUM) |
| JAN 2024 | REVISION 2 |
| OCT 2023 | REVISION |
| JULY 2023 | ISSUED FOR TENDER |

- GENERAL NOTES:
- LOCATIONS OF SITE FEATURES ARE APPROXIMATE AND MAY VARY FROM THAT SHOWN.
 - CONTRACTOR TO VERIFY QUANTITIES AND DIMENSIONS AND REPORT ANY DISCREPANCY TO THE CONSULTANT BEFORE PROCEEDING.
 - THIS DRAWING IS NOT TO BE SCALED.
 - THIS DRAWING IS NOT TO BE USED FOR CONSTRUCTION.

KH CONSULTANTS
Professional Engineer & Environmental

311 MATHESON BOULEVARD EAST
MISSISSAUGA, ONTARIO L4Z 1X8
TEL. (905) 890-9000 FAX. (905) 890-9005

CLIENT ADDRESS:
peel District School Board
933 CENTRAL PARKWAY WEST
MISSISSAUGA, ON

PROJECT NAME:
INTERIOR DOOR REPLACEMENT
AT
HOMELANDS SENIOR PUBLIC SCHOOL
2420 HOMELANDS DRIVE,
MISSISSAUGA, ON

DRAWING TITLE:
ADDITIONAL DETAILS
(ARCHITECTURAL AND STRUCTURAL)

| PROJ. NO.: | DRAWING NO.: |
|----------------|--------------|
| 28769 | SK8 |
| DRW. BY: AF | |
| CHK. BY: NH | |
| SCALE: NTS | |
| DATE: MAY 2024 | |