



# Site Review Report

## Project Information

Date: July 14, 2023	Pinchin Representative: Andres Gimenez	Report Number: 03 Pinchin File: 233190.003
Project Name: Type 3 Asbestos Abatement	Site Address: 23 Barberry Place, Toronto, Ontario	
Client: City of Toronto	Client File Number: N/A	
Contractor: The BearStar Group Inc.	Arrival on Site: 8:30 AM Number of Workers: 1	

## Distribution:

cc:	Sara Reid	City of Toronto	Sara.Reid@toronto.ca
	Inder Bhamra	City of Toronto	inder.bhamra@toronto.ca
	Anthony Ghazalian	The BearStar Group Inc.	anthony@bearstargroup.com
	Andres Gimenez	Pinchin Ltd.	agimenez@pinchin.com

## Description of Work in Progress

Material	Work Area	Work in Progress	Type of Review	Status
Asbestos	Work Area 1: 23 Barberry Place	Intrusive Investigation	Progress	Acceptable

## Discussion Points and Action Items

### Work Area 1: 23 Barberry Place

An intrusive investigation was conducted to delineate the location of asbestos-containing white paper insulation under hardwood flooring was conducted within the 2<sup>nd</sup> Floor and Ground Floor.

- Asbestos-containing white paper insulation was observed to be present under hardwood flooring within Corridor (Location 17) and select Bedrooms (Locations 13, 14 and 15) on the 2<sup>nd</sup> Floor.
- Non-asbestos black paper insulation was observed to be present within East Bedroom (Location 16) and Washrooms (Location 12 and 13) on the 2<sup>nd</sup> Floor, and Kitchen (7 Location) and Living Room (Location 6) on the Ground Floor.
- No insulation was present within Stairwells.

### Recommendation:

Based on the findings of the investigation, asbestos-containing white paper insulation was observed to be installed in an inconsistent pattern; therefore, it is presumed to be present in all areas of the 2<sup>nd</sup> Floor. Type 3 abatement procedures, as per O. Reg. 278/05, are required for the removal of hardwood flooring and associated paper insulation throughout the 2<sup>nd</sup> Floor (including bedrooms, corridor, closets and washrooms). Approximately 600 square feet of asbestos-containing friable white paper insulation is assumed to be present.

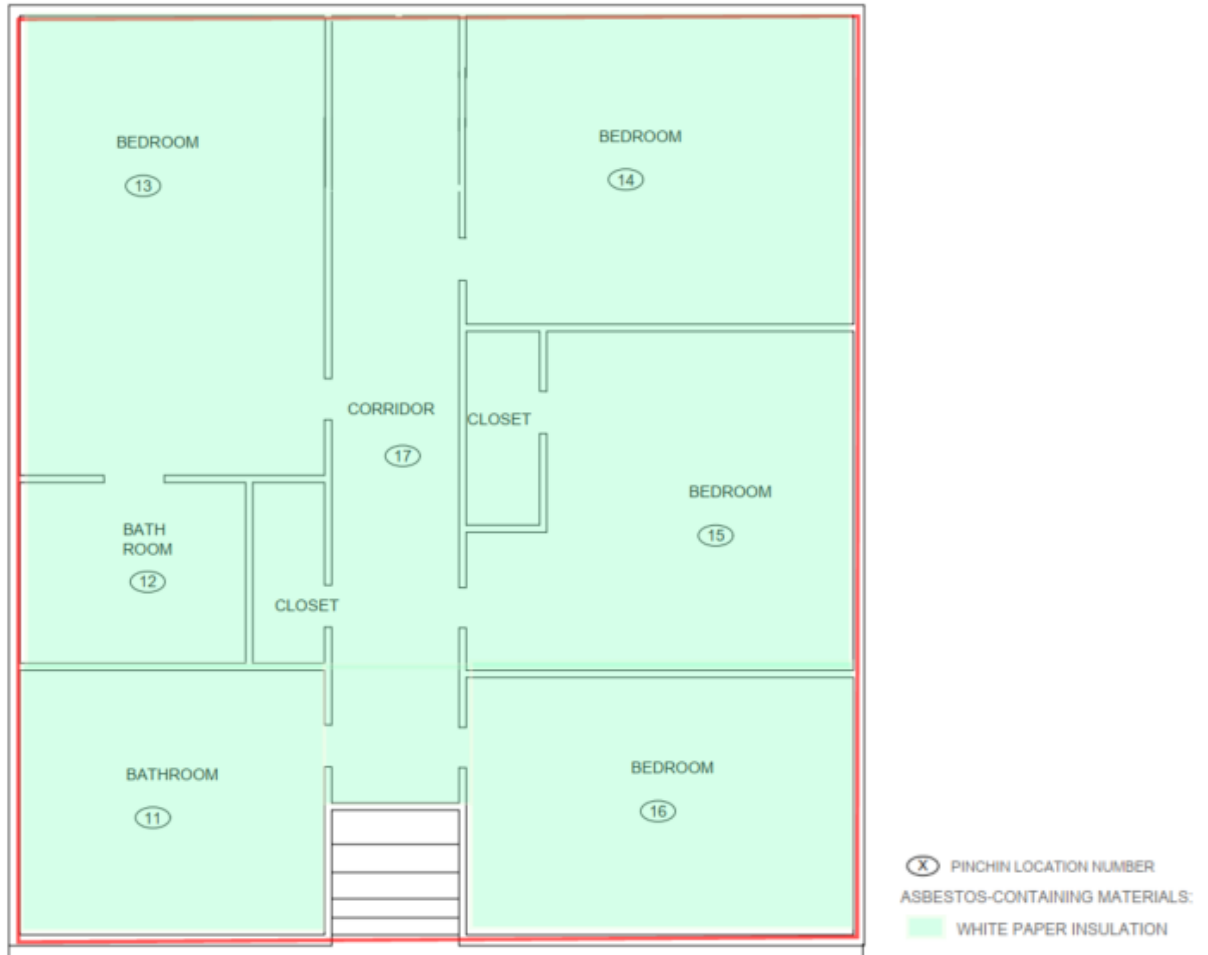

Assessed Area, 2<sup>nd</sup> Floor



Asbestos-containing white paper insulation found under original hardwood flooring, Bedroom, 2<sup>nd</sup> Floor, Location 13.



Asbestos-containing white paper insulation found under original hardwood flooring, Bedroom, 2<sup>nd</sup> Floor, Location 14.



Asbestos-containing paper insulation found under original hardwood flooring, Bedroom, 2<sup>nd</sup> Floor, Location 15.



Asbestos-containing paper insulation found under original hardwood flooring, Corridor, 2<sup>nd</sup> Floor, Location 17.



Non-asbestos paper insulation found under original hardwood flooring, Bedroom, 2<sup>nd</sup> Floor, Location 16.



Non-asbestos paper insulation found under original hardwood flooring, Washroom, 2<sup>nd</sup> Floor, Location 11.



Non-asbestos paper insulation found under original hardwood flooring, Kitchen, Ground Floor, Location 7.



Non-asbestos paper insulation found under original hardwood flooring, Living room, Ground Floor, Location 6.