



Site Review Report

Project Information

Date: August 15, 2023	Pinchin Representative: Andres Gimenez	Report Number: 04 Pinchin File: 233190.004
Project Name: Type 3 Asbestos Abatement	Site Address: 23 Barberry Place, Toronto, Ontario	
Client: City of Toronto	Client File Number: N/A	
Contractor: The BearStar Group Inc.	Arrival on Site: 8:30 AM Number of Workers: 4	

Distribution:

cc:	Sara Reid	City of Toronto	Sara.Reid@toronto.ca
	Inder Bhamra	City of Toronto	inder.bhamra@toronto.ca
	Anthony Ghazalian	The BearStar Group Inc.	anthony@bearstargroup.com
	Andres Gimenez	Pinchin Ltd.	agimenez@pinchin.com

Description of Work in Progress

Material	Work Area	Work in Progress	Type of Review	Status
Asbestos	Work Area 1: 23 Barberry Place	O.Reg. 278/05 Type 3 removal of hardwood flooring and concealed asbestos-containing white paper insulation.	Clean Site Preparation	Acceptable

Discussion Points and Action Items	<p>The clean site preparation inspection was acceptable. The Type 3 enclosure construction meets the requirements outlined in Ontario Asbestos Regulation O.Reg 275/05.</p> <p>Asbestos-containing white paper insulation, observed to be installed in an inconsistent pattern, concealed under hardwood flooring will be removed throughout the 2nd Floor (including bedrooms, corridor, closets and washrooms). Approximately 600 square feet of asbestos-containing friable white paper insulation is assumed to be present.</p>
---	--

Observations – Work Area 1: 23 Barberry Place

Site Isolation & Facilities/Equipment	Acceptable	<p>The enclosure was constructed using 6-mil rip-proof white polyethylene sheeting and sealed with the duct tape. All seams are intact, no rips or tears were noted during the inspection. Openings on ceiling and floors were protected with polyethylene sheeting which was taped and sealed well.</p> <p>The entrance decontamination unit to the enclosure has been constructed with double-flapped doors providing adequate seals through each chamber. A running shower with hold water was present in the decontamination area and operational at the time of the inspection.</p> <p>Openings on ceiling on the ground floor were covered using 6-mil rip-proof white polyethylene sheeting and sealed with the duct to tape to meet negative pressure within the enclosure on the 2nd Floor.</p> <p>Appropriate asbestos warning signage is posted at the entrance to the</p>
--	-------------------	--

		enclosure and a Notice of Project was posted and present on site.
Negative Pressure	Acceptable	Three (3) negative air pressure units are installed exhausting filtered air out of the enclosure. The negative air pressure units were D.O.P. tested and certified on August 14, 2023. The negative air pressure displayed on the manometer was -0.025 cubic inches of water.
Personal Protective Equipment	Acceptable	Once the abatement work is underway, all abatement workers entering or within the enclosure are required to wear the appropriate personal protective equipment (PPE) required for the job including, but not limited to, safety work boots, hard hats, disposable coveralls (e.g. Tyvek suites) and NIOSH approved full face respirators with P-100 filters.
Dust Suppression	Acceptable	HEPA vacuums and amended water are to be used during work and for the purposes of cleaning. Waste shall be cleaned and bagged frequently throughout the work.
Cleaning	Acceptable	When the abatement has been completed the enclosure must be free of visible dust and debris. All surfaces not covered in polyethylene sheeting should be cleaned and free of any visible dust or debris. The foreman will contact Pinchin Ltd. once cleaning has been completed to arrange a time for the visual clearance inspection.
Waste Handling	Acceptable	All waste must be placed into yellow asbestos waste bags, sealed shut with tape, double bagged in a 6 mil clear polyethylene bag, and sealed shut with tape. All waste is to be removed from site and disposed of by the contractor in accordance with R.R.O. 1990, Reg 347.
Other	Acceptable	Pre-contamination visual inspection was acceptable. Pinchin informed the contractor they can proceed with the abatement. Pinchin will return to site to conduct a visual clearance inspection.

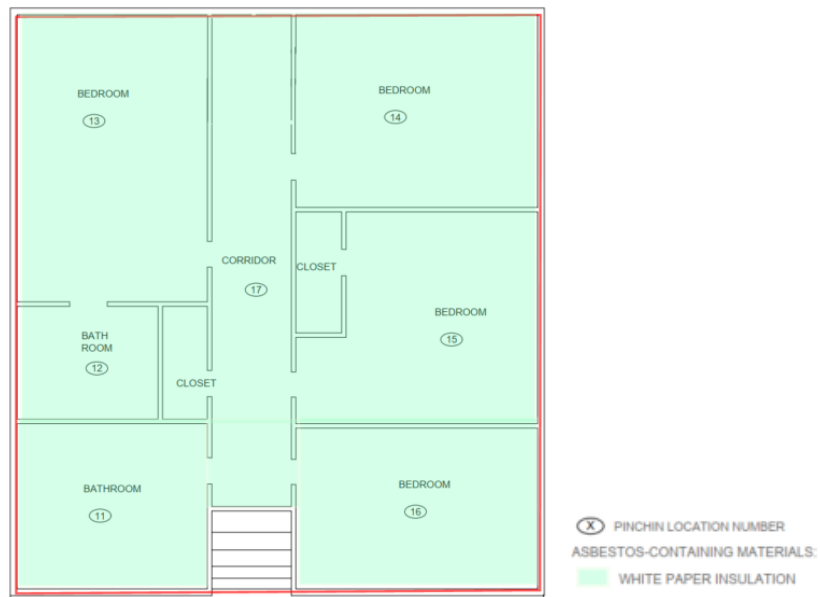

Assessed Area, 2nd Floor Abatement Work Area, Highlighted in Red



Asbestos warning sign posted on the entrance to the enclosure



Sufficient negative air pressure displayed on manometer.



Notice of Project posted on the entrance to the enclosure



View of negative air unit venting outside of the building.



View of negative air.



View of negative air unit venting outside of the building.



View of inside enclosure.



View of floor registers covered with poly.



View of inside enclosure.



View of inside enclosure.



Asbestos-containing white paper insulation under original hardwood flooring to be abated, Bedroom, 2nd Floor, Location 13



Asbestos-containing white paper insulation found under original hardwood flooring to be abated, Bedroom, 2nd Floor, Location 14.