

GENERAL NOTES (WINDOW REPLACEMENTS):

ALLOW IN PRICE FOR PAINT TOUCH UPS AT BLOCK INTERIOR AT ALL WINDOW REPLACEMENT LOCATIONS. NO EXTRAS WILL BE ALLOWED. ALLOW FOR PAINTING OF EXISTING LINTELS.

WINDOW CONTRACTOR TO ALLOW FOR ALL NEW BLOCKING AND TRIMS AROUND ALL WINDOWS TO SUIT NEW INSTALLS. NO EXTRAS WILL BE ALLOWED.

NEW WINDOW BLINDS AS SPECIFIED IN ALL UNITS

PREFINISHED ALUMINUM SILLS TO MATCH WINDOW FRAMING FOR ALL UNITS - NO SHARP EDGES.

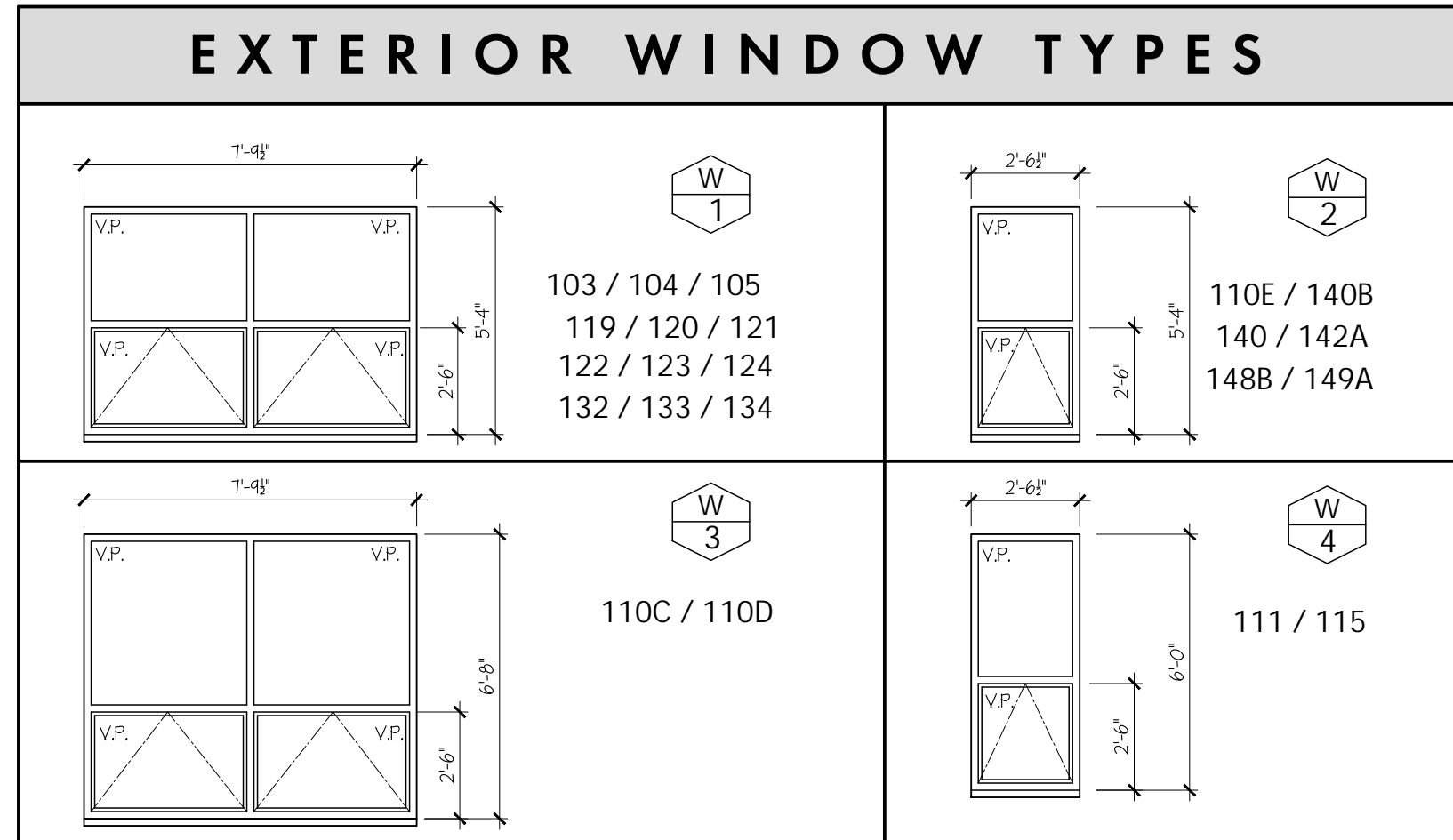

REMOVALS AT ALL LOCATIONS - NO EXTRAS WILL BE ALLOWED

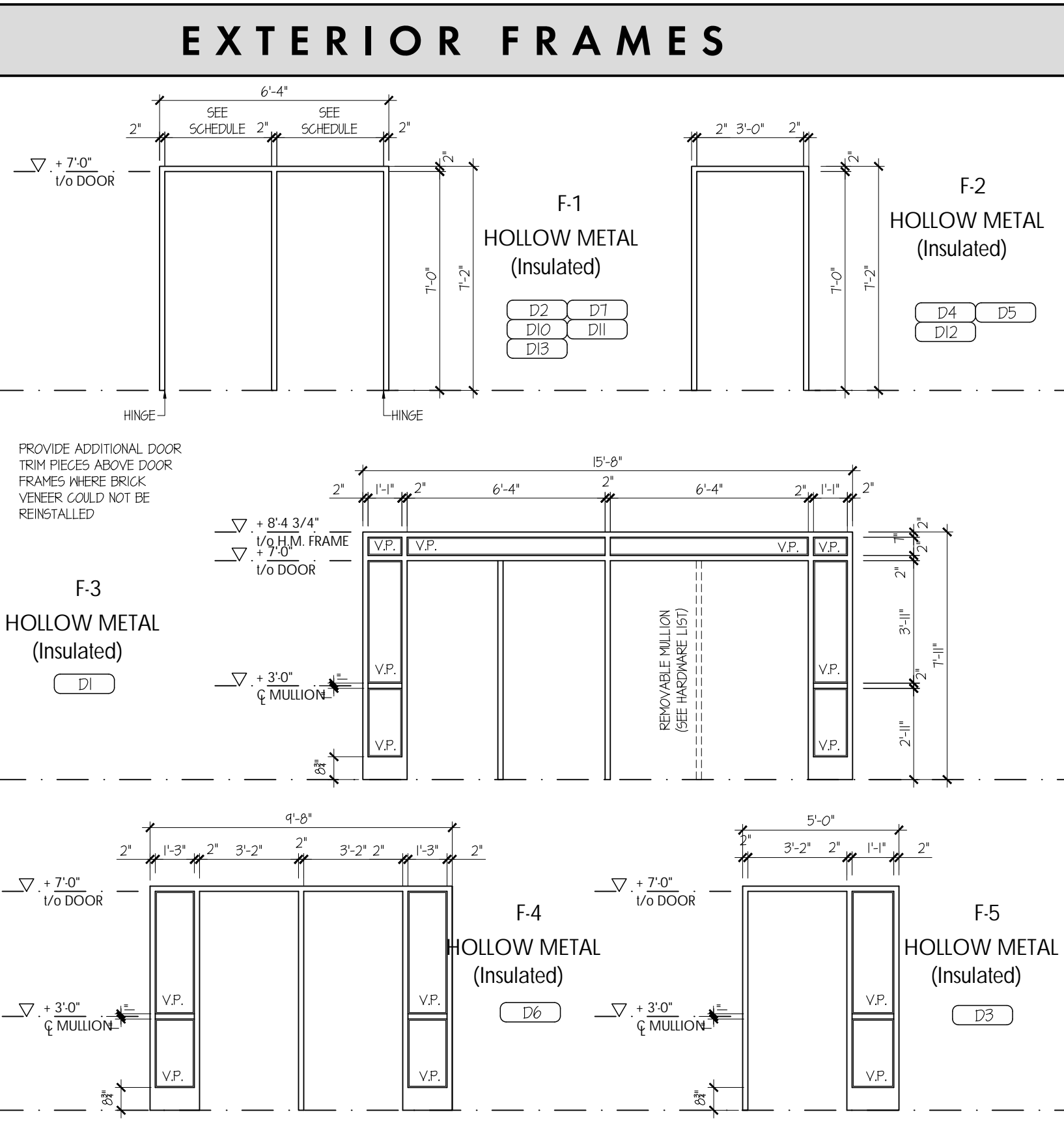

DOOR TYPES

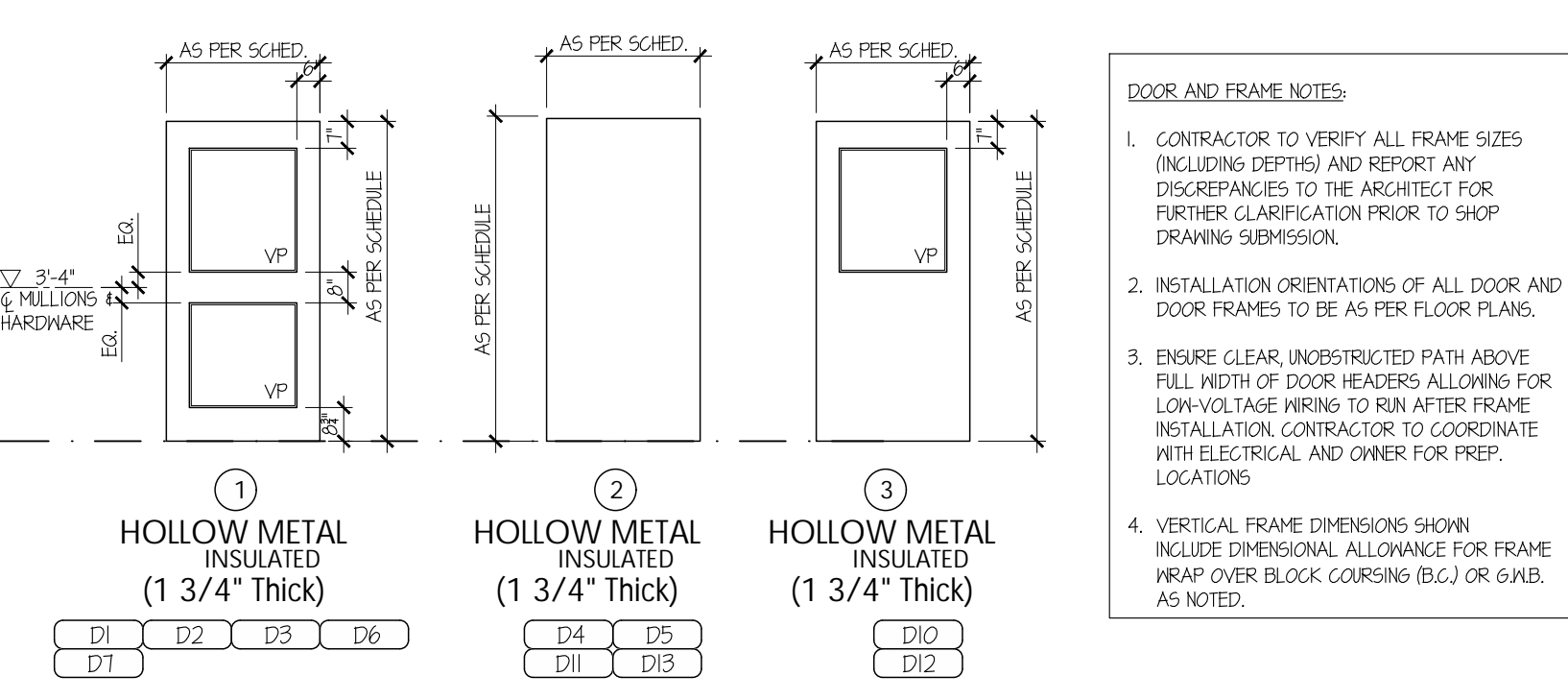

PLAN NOTES:

- EXISTING POWER DOOR OPERATORS AND PUSH BUTTONS TO BE REMOVED AND RE-USED. RIN CONDUIT CONCEALED IN CEILING WHERE POSSIBLE AND RIN STRAIGHT DOWN TO DEVICE. ANY NEW EXPOSED CONDUIT TO BE PAINTED.
- EXISTING CARD READER TO BE REMOVED FROM EXISTING DOOR FRAME PRIOR TO DEMOLITION AND TO BE RE-INSTALLED ON HALL BESIDE DOOR AND BE RE-WIRED TO SUIT. ALLOW FOR ADJUSTMENTS AND REINFORCEMENT FOR PROPER OPERATION.
- EXISTING AIRPONE CAMERA TO BE REMOVED FROM EXISTING DOOR FRAME AND INSTALLED ON BLOCK WALL BESIDE DOOR TO SUIT.
- ALLOW FOR COSTS FOR ALL REMOVALS AND RE-INSTALLATION INCLUDING ANY WORK FOR NEW EXISTING VOLTAGE WIRING IN CONTRACT.
- PROVIDE FOR ADDITIONAL DOOR TRIM PIECES ABOVE STANDARD DOOR FRAMES WHERE BRICK VENEER IS REMOVED TO U5 EXISTING LINTEL. (APPROX 3'-4')

(X) REFERS TO SCHOOL'S ENTRANCE #

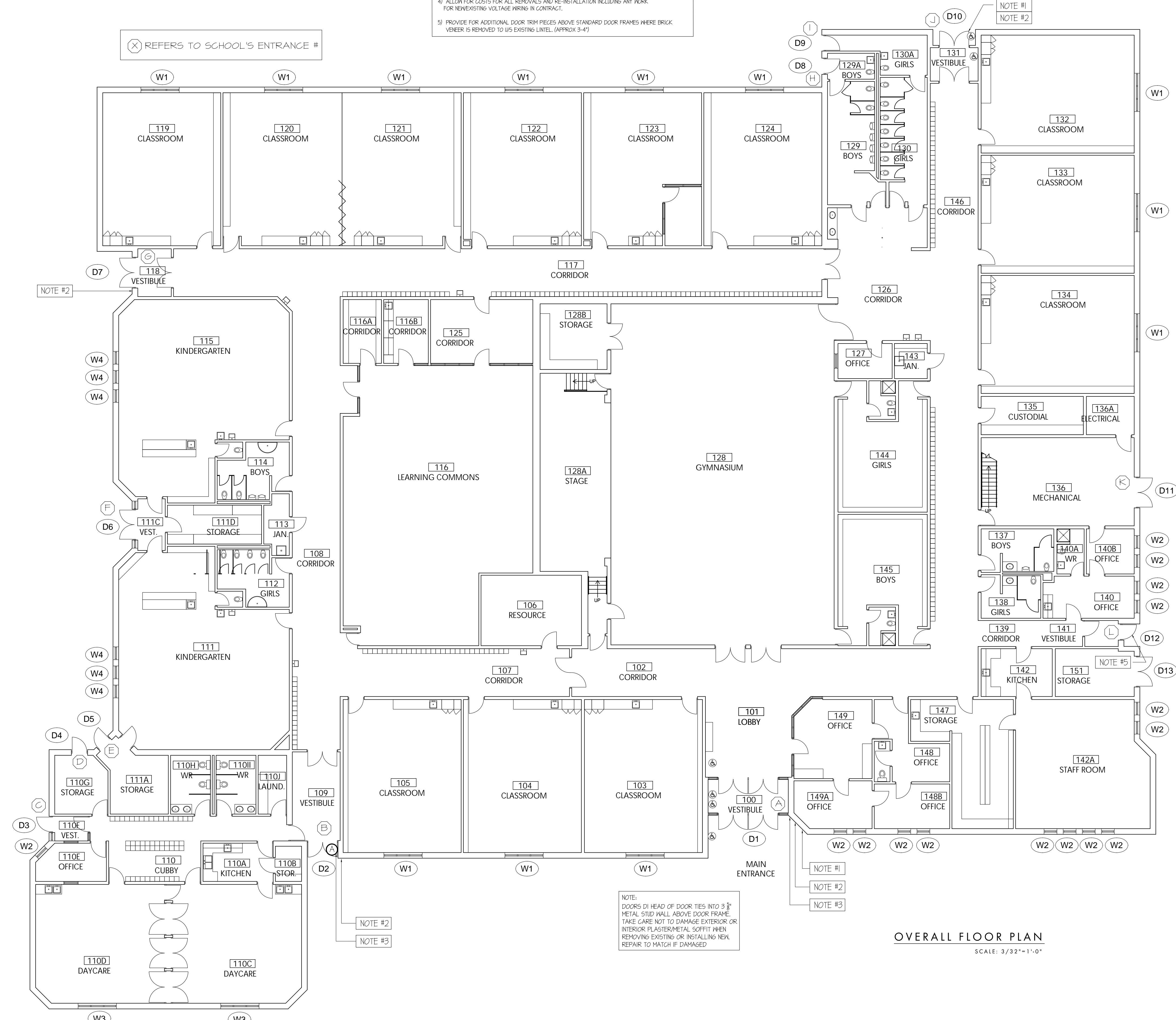

THESE DRAWINGS ARE NOT TO BE SCALED.
ALL DRAWINGS, THE DESIGN AND THE DETAILS THEREON REMAIN THE PROPERTY OF THE ARCHITECT AND ARE NOT TO BE ALTERED, RE-USED OR REPRODUCED WITHOUT THE ARCHITECT'S EXPRESS WRITTEN CONSENT.
THE CONTRACTOR MUST FIELD VERIFY ALL DIMENSIONS AND MUST CORRECT & CORRELATE ALL DETAILS WITHIN THE FULL DRAWING PACKAGE BEING RESPONSIBLE FOR SAME THROUGHOUT CONSTRUCTION, REPORTING ANY DISCREPANCIES TO THE ARCHITECT PRIOR TO COMMENCING THE RELEVANT WORK.
ALL DRAWINGS, DETAILS & SPECIFICATIONS REPRESENTED IN THE DRAWINGS ARE TO BE USED FOR CONSTRUCTION ONLY WHEN ISSUED BY THE ARCHITECT AND NOTED ACCORDINGLY IN THE 'ISSUE/REVISIONS' BOX HEREON.

- ISSUED FOR TENDER JAN 25
- ISSUED FOR CONST.
- AS BUILT

PROJECT:
Window and Door Upgrades to:
Lincoln Alexander School
50 Ravebury Drive
Hamilton, ON

For the HWDSB
SEAL:

WHITELINE Architects Inc.
83 ONTARIO STREET
ST. CATHARINES
ONTARIO L2R 5J5
905-688-6087
www.whitelinearchitects.com

DRAWING TITLE:
Floor Plan Door and Window Types

SCALE:
AS NOTED

DRAWN:
SB

DATE:
DEC 2024

PROJECT #:
2418

DRAWING #:
A1

PLOTTED 12/17/2024 12:21 PM

THESE DRAWINGS ARE NOT TO BE SCALED.
 ALL DRAWINGS, THE DESIGN AND THE DETAILS THEREON REMAIN THE PROPERTY OF THE ARCHITECT AND ARE NOT TO BE ALTERED, RE-USED OR REPRODUCED WITHOUT THE ARCHITECT'S EXPRESS WRITTEN CONSENT.
 THE CONTRACTOR MUST FIELD VERIFY ALL DIMENSIONS AND MUST CONFIRM & CORRELATE ALL DETAILS WITHIN THE FULL DRAWING PACKAGE BEING RESPONSIBLE FOR SAME THROUGHOUT CONSTRUCTION, REPORTING ANY DISCREPANCIES TO THE ARCHITECT PRIOR TO COMMENCING THE RELEVANT WORK.
 ALL DRAWINGS, DETAILS & SPECIFICATIONS REPRESENTED IN THE DRAWINGS ARE TO BE USED FOR CONSTRUCTION ONLY WHEN ISSUED BY THE ARCHITECT AND NOTED ACCORDINGLY IN THE "ISSUE/REVISIONS" BOX HEREON.

- 1. ISSUED FOR TENDER JAN 25
- 2. ISSUED FOR CONST.
- 3. AS BUILT

PROJECT:
 Window and Door
 Upgrades to:
**Lincoln
 Alexander
 School**
 50 Ravebury Drive
 Hamilton, ON

For the HWDSB
 SEAL:



WHITELINE
 Architects Inc.

83 ONTARIO STREET
 ST. CATHARINES
 ONTARIO L2R 5J5
 905-688-6087
 www.whitelinearchitects.com

DRAWING TITLE:
**ELEVATIONS
 DOOR SCHEDULE**

SCALE:
 AS NOTED

DRAWN:
 D GORDON

DATE:
 OCTOBER 27, 2020

PROJECT #:
 2024

DRAWING #:
A2



ALLOW FOR ALL ELECTRICAL ITEMS TO BE REMOVED / REINSTATED AT ALL DOORS AND FRAMES UNDER CONTRACT ALL EXTERIOR DOORS HAVE SECURITY CONTACTS
 ALL EXTERIOR DOORS HAVE SECURITY CONTACTS WHICH ARE TO BE REMOVED AND REINSTATED IN BASE BID - REFER TO SPECIFICATIONS FOR HWDSB APPROVED VENDORS FOR THIS WORK

DOOR SCHEDULE

ID #	LOCATION	DOOR	FRAME	RATING	LEGEND NOTE									
NO.	FROM	TO	SIZE	MATERIAL	ELEV.	FINISH	MATERIAL	JAMB	ELEV.	FINISH	DEPTH	FIRE RATING	INSERTS	REMARKS
D1	EXT	100	2 @ 3'-2" x 7'-0" 2 SETS	INSULATED H.M.	1	PAINT	HOLLOW METAL	A	F-3	PAINT	5 3/4"	--	V.P.	AUTO DOOR OPERATOR CARD ACCESS / A-PHONE
D2	EXT	104	2 @ 3'-0" x 7'-0"	INSULATED H.M.	1	PAINT	HOLLOW METAL	A	F-1	PAINT	5 3/4"	--	V.P.	CARD ACCESS A-PHONE
D3	EXT	110F	3'-0" x 7'-0"	INSULATED H.M.	1	PAINT	HOLLOW METAL	A	F-5	PAINT	5 3/4"	--	V.P.	CARD ACCESS
D4	EXT	110G	3'-0" x 7'-0"	INSULATED H.M.	2	PAINT	HOLLOW METAL	A	F-2	PAINT	5 3/4"	--	--	--
D5	EXT	111A	3'-0" x 7'-0"	INSULATED H.M.	2	PAINT	HOLLOW METAL	A	F-2	PAINT	5 3/4"	--	--	--
D6	EXT	111C	2 @ 3'-2" x 7'-0"	INSULATED H.M.	1	PAINT	HOLLOW METAL	A	F-4	PAINT	5 3/4"	--	VP	--
D7	EXT	111B	2 @ 3'-0" x 7'-0"	INSULATED H.M.	1	PAINT	HOLLOW METAL	A	F-1	PAINT	5 3/4"	--	VP	CARD ACCESS
D8	EXT	124A	ETR	INSULATED H.M.	-	PAINT	HOLLOW METAL	-	-	PAINT	-	--	--	--
D9	EXT	130A	ETR	INSULATED H.M.	-	PAINT	HOLLOW METAL	-	-	PAINT	-	--	--	--
D10	EXT	131	2 @ 3'-2" x 7'-0"	INSULATED H.M.	3	PAINT	HOLLOW METAL	A	F-1	PAINT	5 3/4"	--	V.P.	AUTO DOOR OPERATOR CARD ACCESS
D11	EXT	136	2 @ 3'-0" x 7'-0"	INSULATED H.M.	2	PAINT	HOLLOW METAL	A	F-1	PAINT	5 3/4"	--	--	--
D12	EXT	141	3'-0" x 7'-0"	INSULATED H.M.	3	PAINT	HOLLOW METAL	A	F-2	PAINT	5 3/4"	--	--	--
D13	EXT	151	2 @ 3'-0" x 7'-0"	INSULATED H.M.	2	PAINT	HOLLOW METAL	A	F-1	PAINT	5 3/4"	--	--	--

GENERAL NOTES:

- THE INTENT OF THESE DRAWINGS IS TO SHOW APPROXIMATE EXTENT AND NATURE OF REQUIREMENTS ONLY. THE GENERAL CONTRACTOR IS RESPONSIBLE TO VERIFY ACTUAL SITE CONDITIONS AS THEY ARE RELATED TO NEW CONSTRUCTION ITEMS, REPORTING DISCREPANCIES TO THE ARCHITECT AS REQUIRED.
- AT ALL WINDOW AND DOOR LOCATIONS NOTED TO BE REPLACED, CONTRACTOR IS RESPONSIBLE TO REMOVE ALL EXISTING MATERIALS, INCLUDING SECURITY SCREENS AND INTERIOR WINDOW BINDS TO ALLOW FOR EXECUTION OF THE WORK. ALL AREAS TO BE MADE SAFE AND SECURE AT THE END OF WORKING DAY BY PROVIDING SECURED PLYWOOD OVER OPENINGS. CONTRACTOR TO ONLY REMOVE ENOUGH WINDOWING SO THAT THEY CAN REASONABLY CLOSE IN WINDOWS WITHIN A DAY. REMOVAL OF ALL WINDOWS AT ONCE IS NOT ALLOWED.
- IT IS THE GENERAL CONTRACTOR'S RESPONSIBILITY TO REMOVE & RELOCATE ALL EXISTING F.F.E. (FURNITURE, FIXTURES & EQUIPMENT) ITEMS FROM THE SUBJECT SPACE TO OWNER - DESIGNATED STORAGE LOCATIONS (ON-SITE). ITEMS DESIGNATED FOR RE-USE ARE TO BE RELOCATED INTO SUBJECT SPACES FOLLOWING CONSTRUCTION.
- ITEMS TO BE DEMOLISHED SHALL BE DISPOSED OF LEGALLY OFF THE SITE AND COMPLY WITH ALL LOCAL HAULING & DISPOSAL REQUIREMENTS AT THE CONTRACTOR'S EXPENSE.
- THE GENERAL CONTRACTOR SHALL MAINTAIN A SEPARATION BETWEEN AREAS WITHIN THE SCOPE OF WORK AND AREAS OUTSIDE OF THE SCOPE OF WORK BY PROVIDING PLASTIC SHEATHING BETWEEN CONTIGUOUS SPACES AND/OR TEMPORARILY TAPING OF JOINTS AND GAPS TO PREVENT DUST MIGRATION. ALL FURNITURE AND SHELVING TO BE COVERED.
- THE GENERAL CONTRACTOR SHALL CAUSE NO DAMAGE TO EXISTING CONSTRUCTION TO REMAIN WHEREVER POSSIBLE, AND SHALL TAKE SPECIAL CARE NOT TO ENCROUGH ON ADJACENT OCCUPIED AREAS OR AREAS NOT WITHIN THE SCOPE OF WORK. PROTECT ALL EXISTING FINISHES, DOORS, FRAMES, ETC. WHICH ARE TO REMAIN.
- THE GENERAL CONTRACTOR SHALL USE ALL MEANS NECESSARY TO ENSURE THE SAFETY OF ADJACENT OCCUPIED AREAS THROUGH THE ERECTION OF CONSTRUCTION HOARDING.
- IT HAS BEEN CONFIRMED THAT ALL EXISTING WINDOW LOUVERS AND FANS WILL NOT BE RE-USED IN AREAS OF WORK. CONTRACTOR TO REMOVE AND MAKE SAFE ELECTRICAL SERVICES.
- THE ARCHITECT SHALL NOT BE HELD LIABLE FOR ANY ASBESTOS OR OTHER HAZARDOUS MATERIALS ON JOBSITE. REFER TO THE HAZARDOUS MATERIALS REPORT IN THE SPECIFICATIONS AND INCLUDE FOR REMOVAL OF ALL ITEMS DENOTED IN REPORT IN ACCORDANCE WITH THE SPECIFIED PROCEDURES.
- CONTRACTOR TO ALLOW FOR REMOVAL AND RE-INSTALLMENT OF ALL DOOR ALARM CONTACTS ON ALL EXTERIOR DOORS AS WELL AS ANY SWIPE CARD ACCESS DEVICES. REFER TO SPECIFICATIONS FOR LIST OF 52 CERTIFIED INTEGRATORS WHICH CAN BE CONTACTED TO QUOTE ON THIS PROJECT.
- UPON COMPLETION CLEAN THE ENTIRE AREA OF WORK TO A TIDY, UNIFORM CONDITION, REMOVING ALL DEBRIS, DUST PARTITIONS AND ASSOCIATED MATERIALS USED DURING THE WORK. CLEAN ALL AREAS IMPACTED BY THE WORK, INCLUDING BUT NOT LIMITED TO, ADJACENT OCCUPIED AREAS AND AREAS NOT WITHIN THE SCOPE OF WORK.
- ABANDONING ITEMS OR UNUSED UTILITIES IN PLACE IS STRICTLY PROHIBITED, UNLESS SPECIFICALLY PERMITTED BY THE OWNER. ENSURE THAT OBSOLETE MECHANICAL & ELECTRICAL ITEMS ARE REMOVED, CAPPED AND OR HANDLED IN FULL ACCORDANCE WITH AUTHORITIES.
- COMPLY WITH ALL STANDARD LOCAL, REGIONAL, PROVINCIAL, AND NATIONAL SAFETY REQUIREMENTS FOR DEMOLITION.
- AT ALL POINTS OF REMOVAL AND/OR REPAIR, MAKE GOOD & PREPARE ALL DISTURBED FINISHES, MATERIALS & SUBSTRATES AS REQUIRED TO ENSURE CLEAN TIE-IN TO NEWLY SPECIFIED MATERIALS THROUGHOUT. PATCH & REPAIR ALL EXISTING ASSEMBLIES WITH MATCHING MATERIALS UNLESS NOTED OTHERWISE.
- ALLOW FOR SECURE AREA ON SITE FOR PORTABLE TOILET AS WELL AS SEA-CAN FOR STORAGE IF REQUIRED. COORDINATE LOCATION WITH HWDSB PROJECT MANAGER AND SCHOOL.
- CONTRACTOR SHALL REPAIR ANY SOIL OR ASPHALT DAMAGED DUE TO SCAFFOLDING OR OTHER ASSOCIATED WORKS.

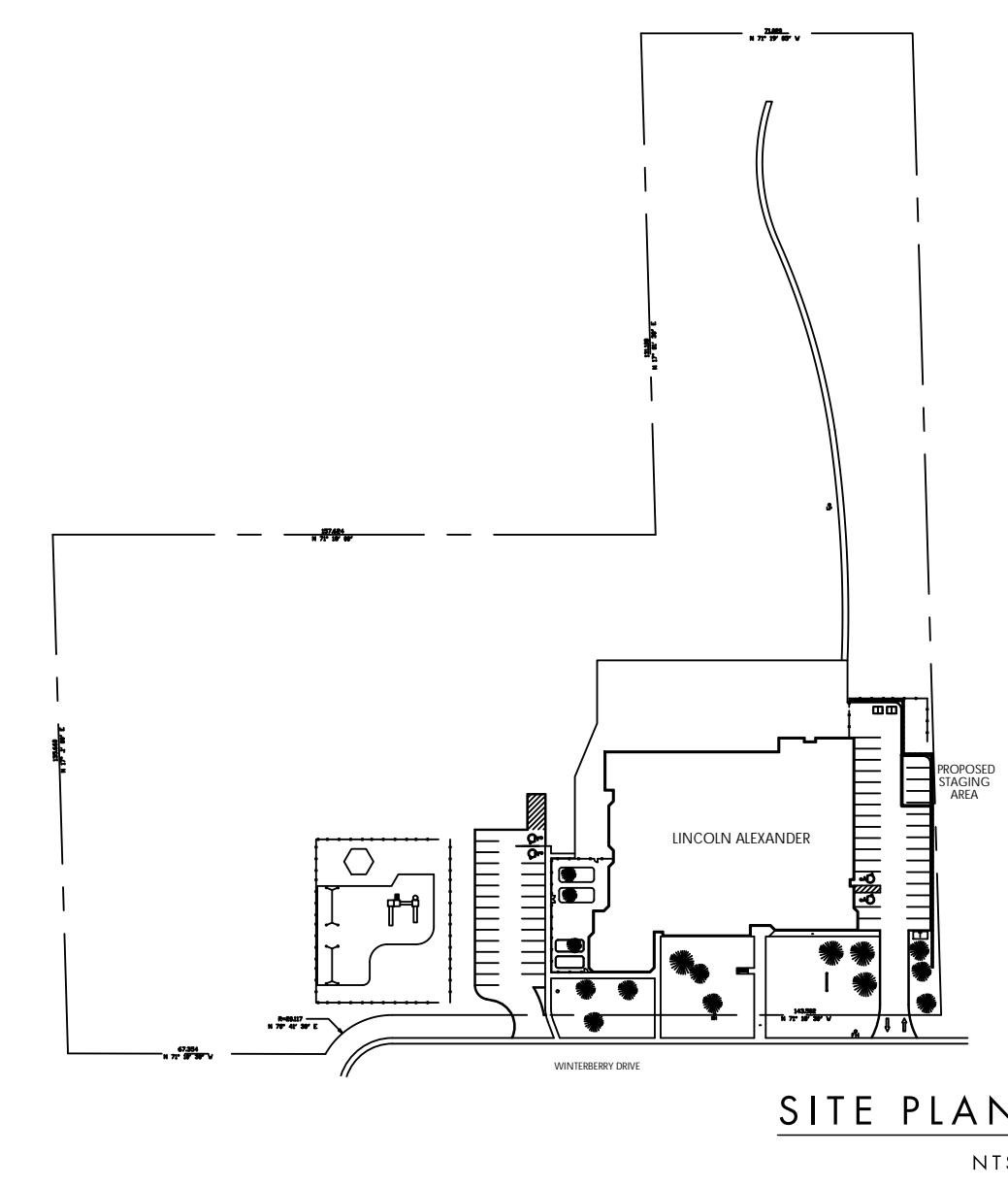

PLOTTED 12/17/2024 12:21 PM