

LOTTRIDGE STREET

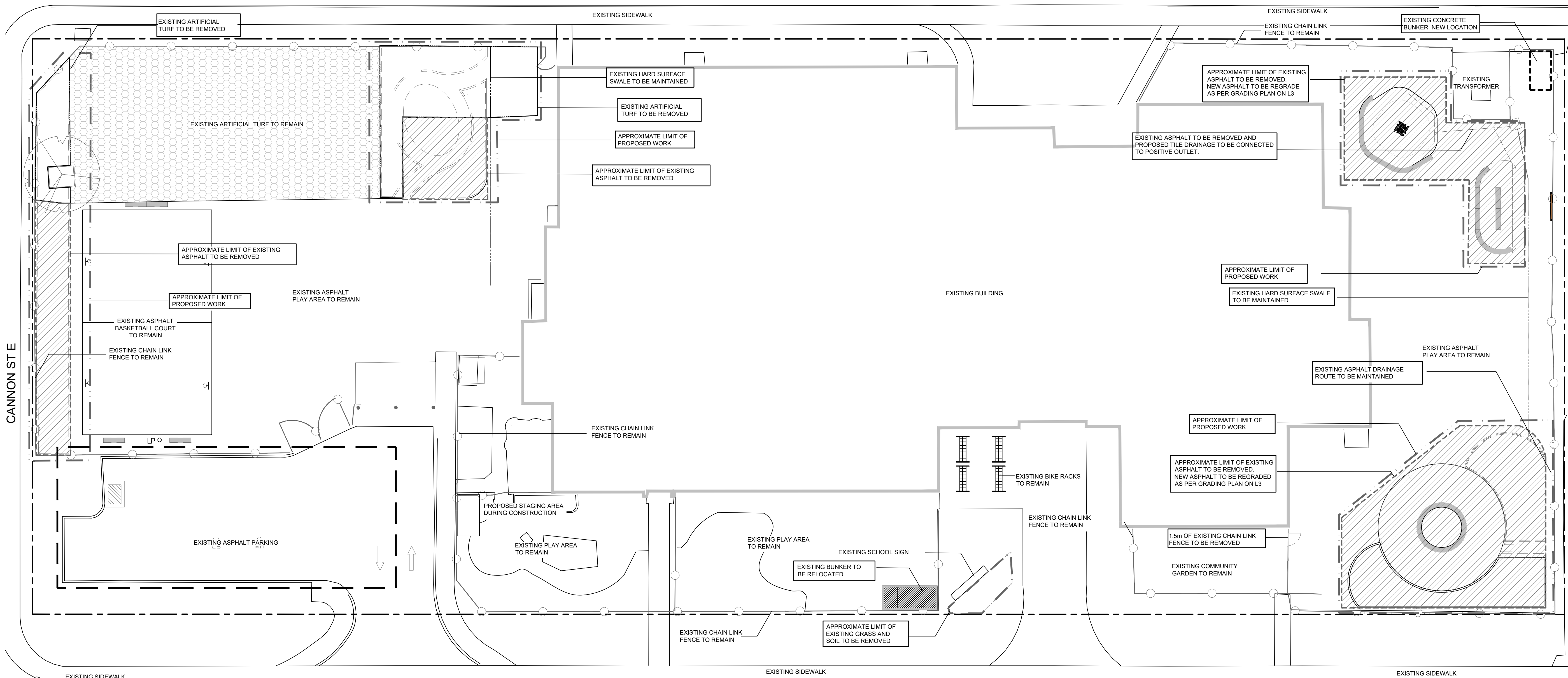

MELROSE AVENUE NORTH

LEGEND

- PROPOSED DECIDUOUS TREE
- PROPOSED BARK MULCH
- PROPOSED ARTIFICIAL TURF
- EXISTING ARTIFICIAL TURF TO REMAIN
- PROPOSED ARMOURSTONE SEATING
- APPROXIMATE LIMIT OF PROPOSED WORK
- EXISTING HARD SURFACE SWALE TO BE MAINTAINED
- 100mm PVC 'BIG O' TILE DRAIN w/ FILTER CLOTH

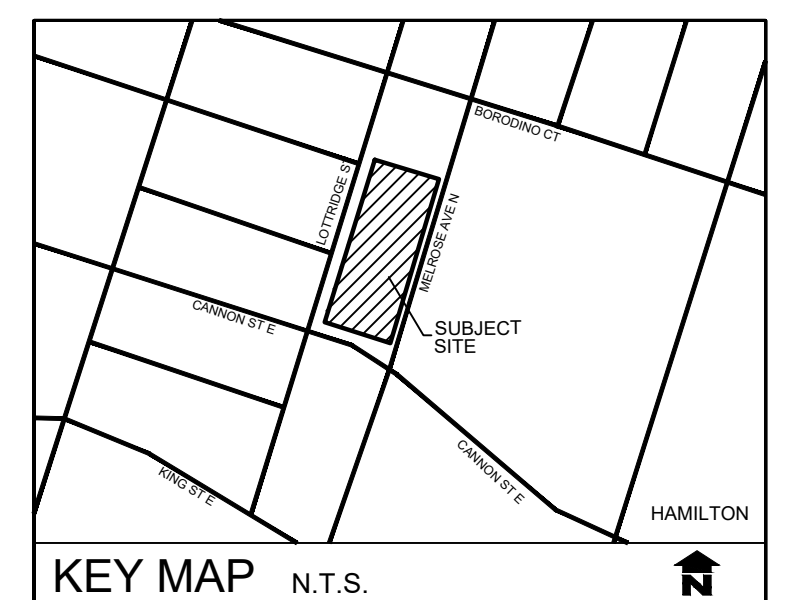

GENERAL NOTES

1. ALL WORKMANSHIP WILL BE TO THE STANDARDS OF LANDSCAPE ONTARIO.
2. ALL PLANT MATERIAL TO BE NO. 1 GRADE NURSERY GROWN IN ACCORDANCE WITH THE CANADIAN STANDARDS FOR NURSERY STOCK, 9TH EDITION, 2017, BY THE CANADIAN NURSERY TRADES ASSOCIATION.
3. BACKFILL WILL CONSIST OF SOIL NATIVE TO THE SITE OR GENERAL SOIL TYPE/CLASS NATIVE TO THE SITE. TOPSOIL TO BE TESTED FOR NUTRIENT VALUE, AND AMENDED FOR OPTIMAL GROWTH AS PER THE RECOMMENDATIONS OF THE SOIL TEST.
4. CONTRACTOR SHALL MAINTAIN ALL LANDSCAPE AREAS UNTIL OWNER'S ACCEPTANCE OF PROJECT.
5. CONTRACTOR TO LOCATE ALL UNDERGROUND UTILITIES.
6. PLANTING MAY BE ADJUSTED TO SUIT LOCATIONS OF SITE UTILITY STRUCTURES/SERVICES.
7. ALL MATERIALS MUST BE APPROVED BY LANDSCAPE ARCHITECT PRIOR TO INSTALLATION.
8. SPREAD MULCH TO A MINIMUM OF 100mm COMPACTED DEPTH ON ALL TREE PITS AND PLANTING BEDS.
9. CHECK AND VERIFY ALL DIMENSIONS AND QUANTITIES PRIOR TO COMMENCEMENT OF WORK. ANY DISCREPANCIES ARE TO BE REPORTED IN WRITING TO THE LANDSCAPE ARCHITECT. QUANTITIES NOTED WITHIN THE PLAN SUPERSEDE THOSE IN THE PLANT LIST. ANY SUBSTITUTIONS SHALL BE APPROVED BY THE LANDSCAPE ARCHITECT.
10. SOD AS MARKED WITH NURSERY SOD ON A MINIMUM OF 100mm OF CLEAN TOPSOIL. FINE GRADE AND SOD ALL BOULEVARD AREAS TO MUNICIPAL SPECIFICATIONS AND REPAIR DAMAGE TO ADJACENT PROPERTIES, AS REQUIRED.
11. FINAL INSPECTION AND ACCEPTANCE OF PLANTING WORK SHALL COINCIDE WITH THE FINAL INSPECTION AND ACCEPTANCE OF ALL WORK INCLUDED IN THE CONTRACT.
12. ALL SEEDED SLOPES 3:1 AND GREATER TO RECEIVE EROSION CONTROL MATTING. PIN SOD ON ALL SLOPES OF 3:1 OR GREATER.
13. SUBMIT A WRITTEN GUARANTEE TO THE EFFECT THAT ALL PLANTS ACCEPTED DURING THE PERIOD OF JANUARY 1st TO JULY 15th SHALL BE GUARANTEED UNTIL JULY 15th THE FOLLOWING YEAR. PLANTS ACCEPTED DURING THE PERIOD OF JULY 15th TO DECEMBER 31st SHALL BE GUARANTEED FOR ONE YEAR FROM THE DATE OF ACCEPTANCE. THE GUARANTEE PERIODS LISTED ABOVE SHALL APPLY TO ALL "NURSERY GROWN" PLANTS.
14. AT THE TIME OF FINAL INSPECTION ALL PLANTS SHALL BE IN A HEALTHY, VIGOROUS GROWING CONDITION, PLANTED IN FULL ACCORDANCE WITH DRAWINGS AND CONDITIONS.
15. EXISTING CONDITION INFORMATION AS PER HAMILTON-WENTWORTH DISTRICT SCHOOL BOARD.
16. TOPOGRAPHIC SURVEY AS PER MTE AND IS FOR INFORMATION ONLY.



REVISIONS

no.	date	description	by
1.	Mar 26 26	Issued for Tender	EH

Prince of Wales School
Elementary school
City of Hamilton

Construction Management
and Removal Plan



PROJECT NO.: 2025-68	DRAWN BY: EH
SCALE: 1:200	DESIGNED BY: EH
SHEET:	APPROVED BY: AWH
L1	PLOT DATE: Mar 26, 2025

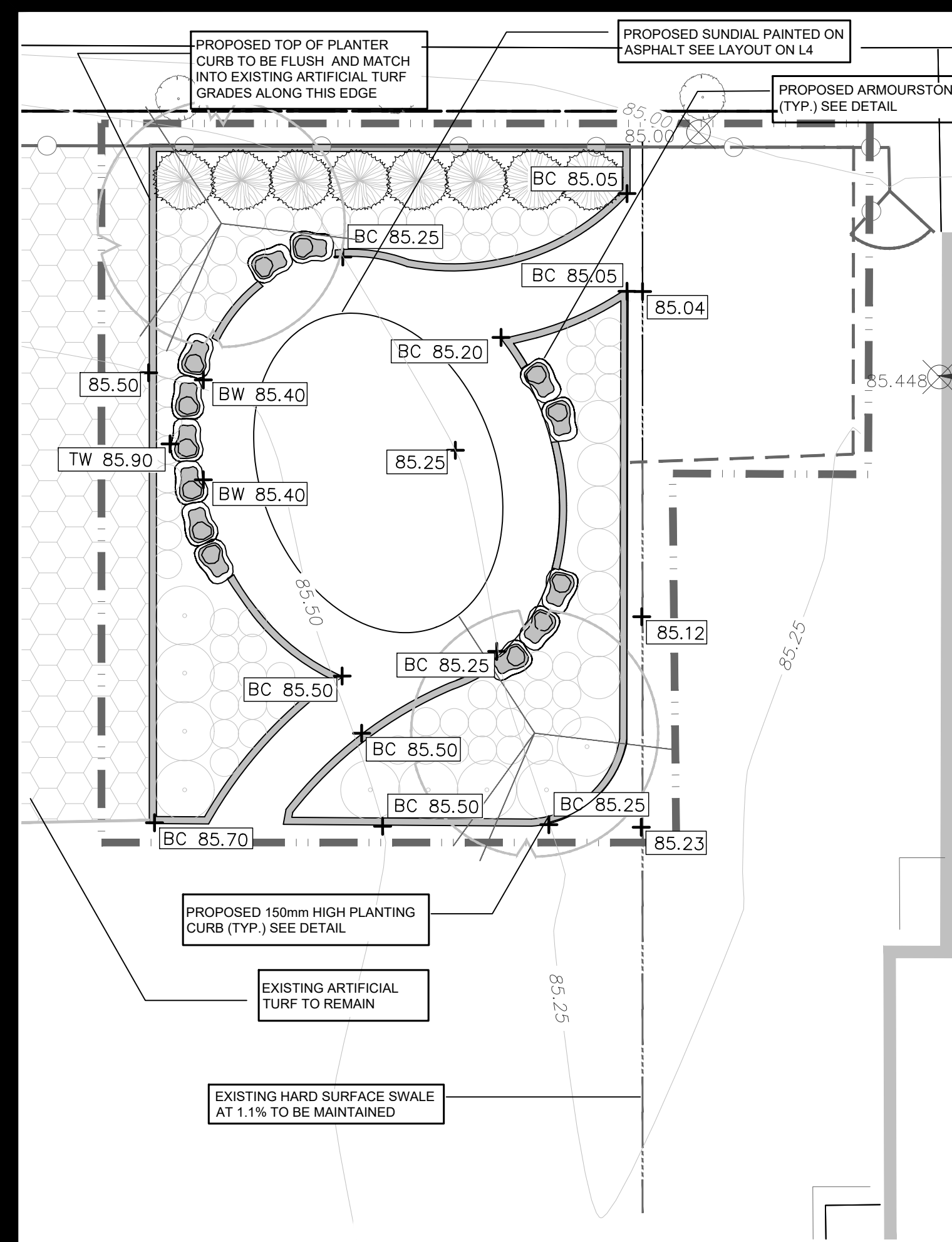

4 SUNDIAL GRADING PLAN
1:100

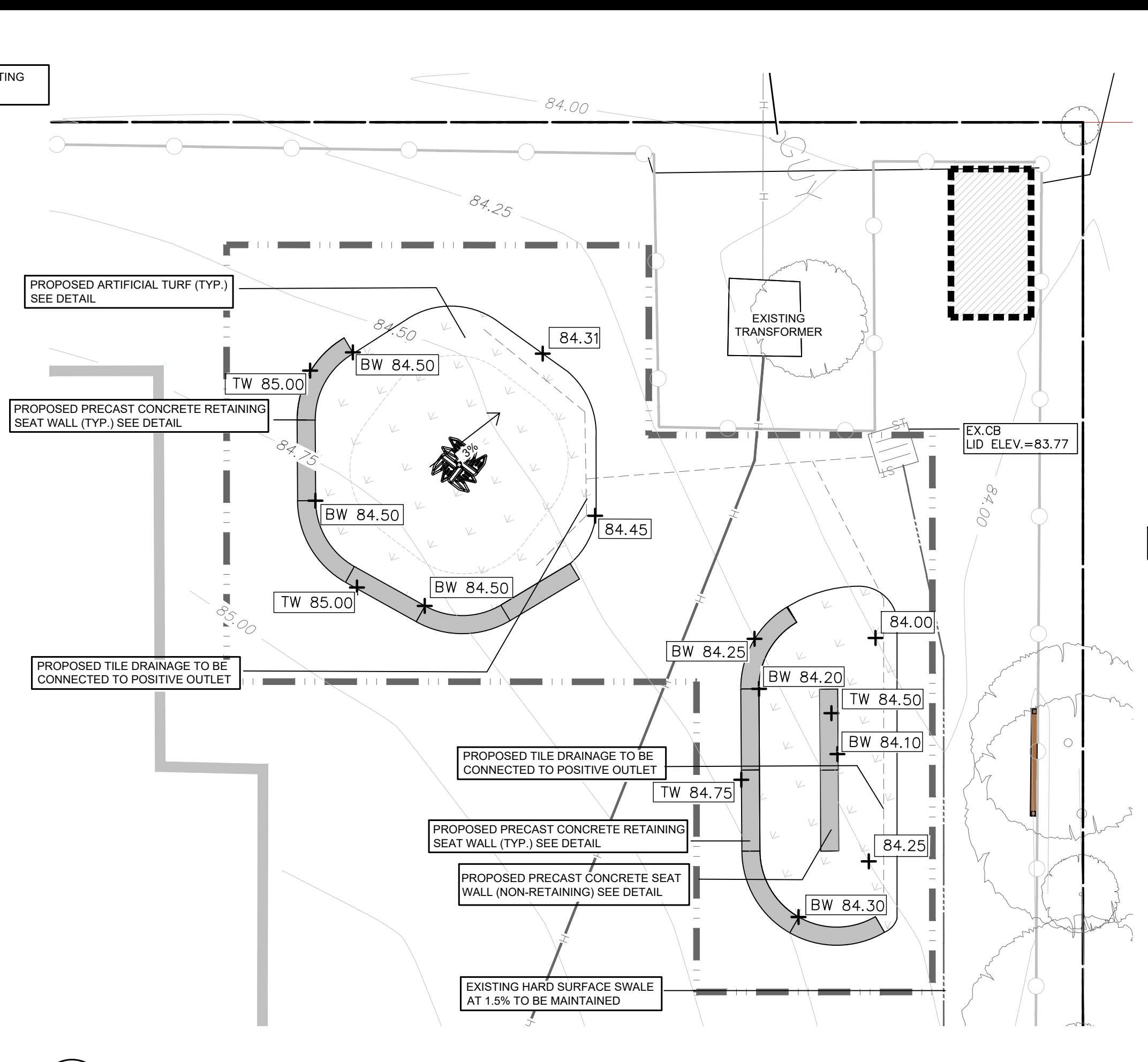

5 OUTDOOR CLASSROOM GRADING PLAN
1:100

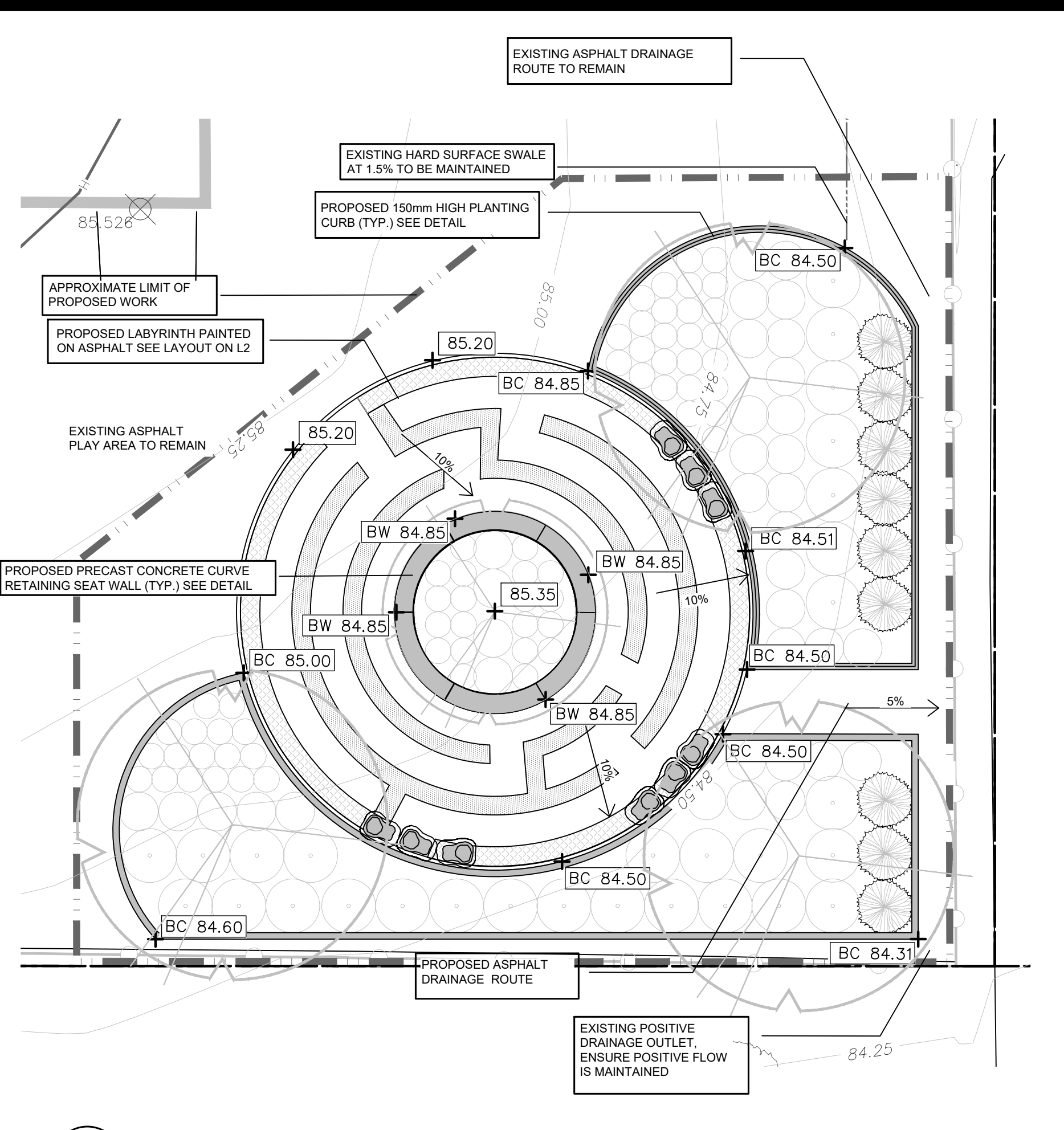

6 LABYRINTH GRADING PLAN
1:100

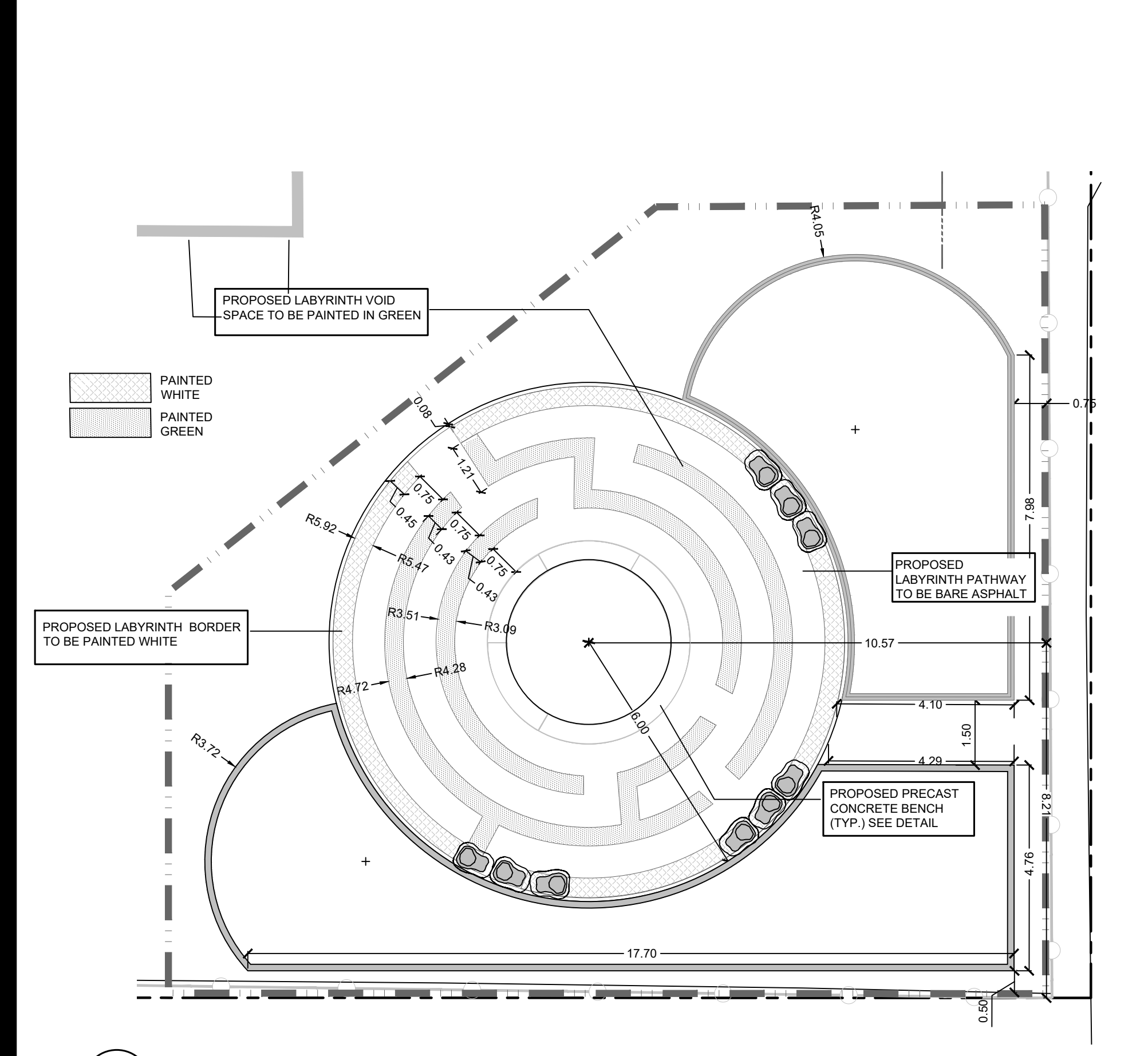

7 LABYRINTH DIMENSION PLAN
1:100

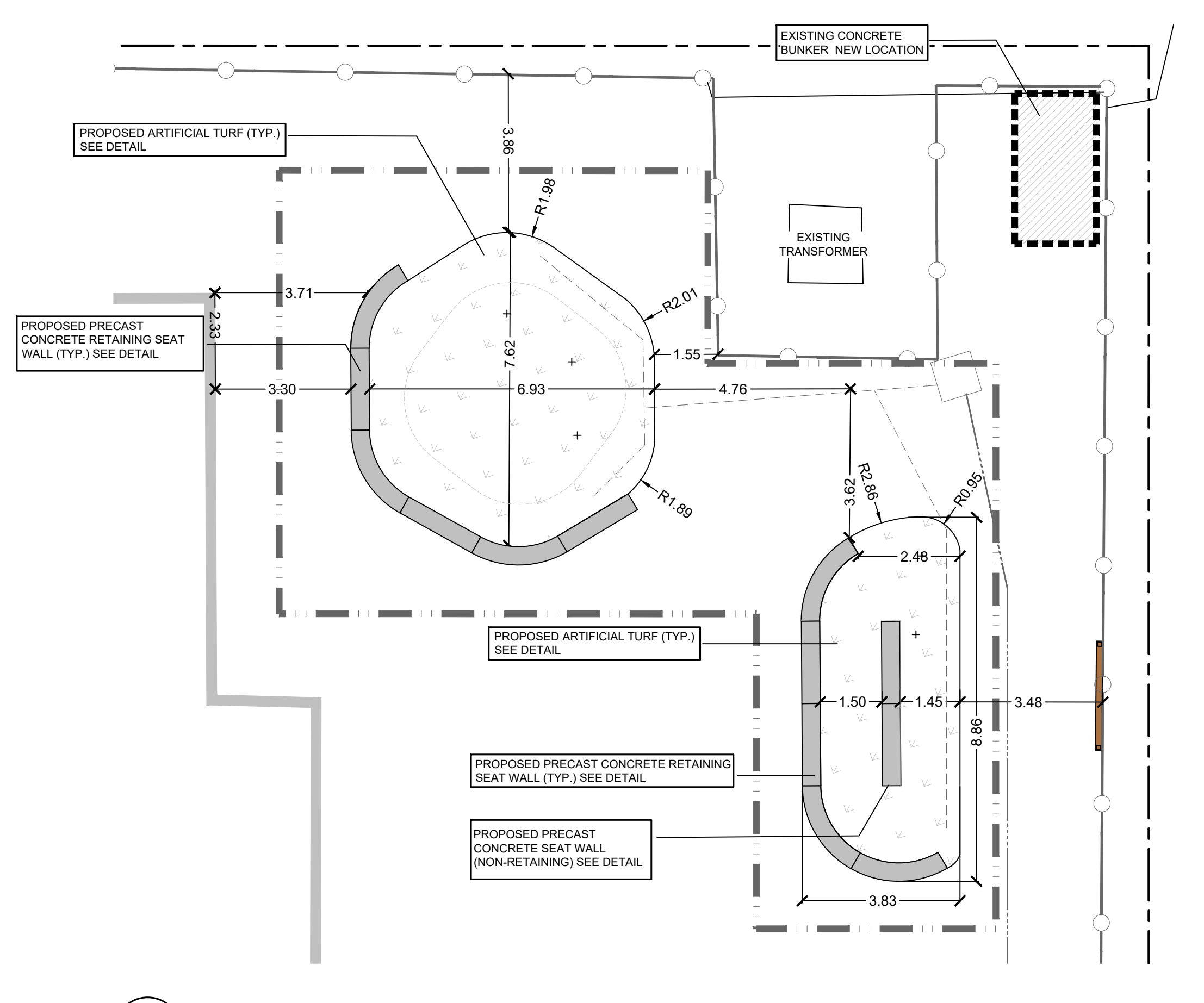

8 OUTDOOR CLASSROOM DIMENSION PLAN
1:100

LEGEND

- PROPOSED DECIDUOUS TREE
- PROPOSED BARK MULCH
- PROPOSED ARTIFICIAL TURF
- EXISTING ARTIFICIAL TURF TO REMAIN
- PROPOSED ARMOURSTONE SEATING
- HILL DESIGN PROPOSED GRADE
- EXISTING GRADES AS PER MTE TOPOGRAPHIC SURVEY DATED MARCH 17, 2026.
- LID ELEVATION FOR EXISTING CATCH BASIN
- APPROXIMATE LIMIT OF PROPOSED WORK
- EXISTING HARD SURFACE SWALE TO BE MAINTAINED
- 100mm PVC 'BIG O' TILE DRAIN c/w FILTER CLOTH
- EXISTING CONTOURS AS PER MTE TOPOGRAPHIC SURVEY DATED MARCH 17, 2026.

BENCHMARK No. 0011965U116
ELEVATIONS SHOWN HEREON ARE GEODETIC AND ARE REFERRED TO A TABLET IN NORTH CONCRETE FOUNDATION WALL OF KING GEORGE SCHOOL, MIDWAY BETWEEN BEECHWOOD AVENUE AND CANNON STREET, OPPOSITE PRIMROSE AVENUE, 2.45m EAST OF SIDE ENTRANCE DOOR, 61cm WEST OF A WINDOW, 30cm BELOW BRICK.
BENCH MARK ELEVATION = 85.397m

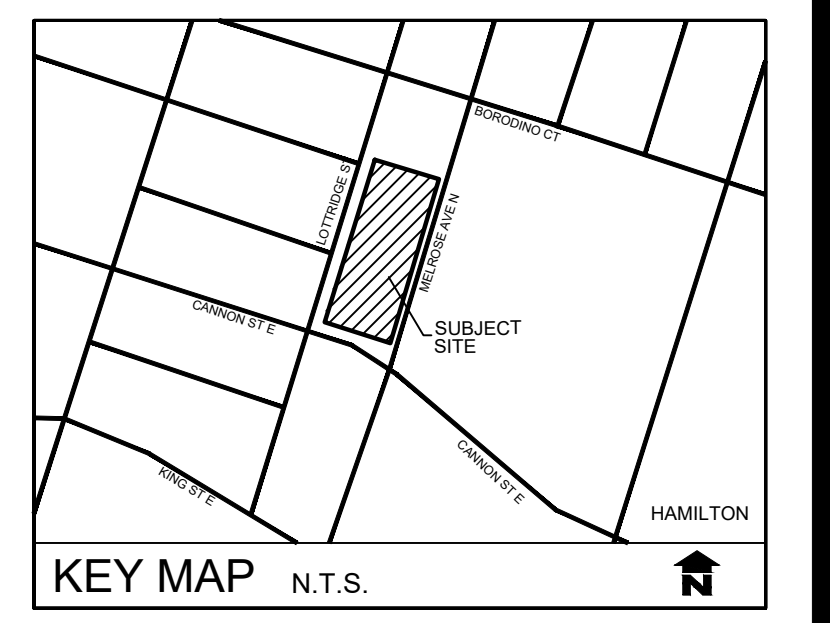

GENERAL NOTES

1. ALL WORKMANSHIP WILL BE TO THE STANDARDS OF LANDSCAPE ONTARIO.
2. ALL PLANT MATERIAL TO BE NO.1 GRADE NURSERY GROWN IN ACCORDANCE WITH THE CANADIAN STANDARDS FOR NURSERY STOCK, 9TH EDITION, 2017, BY THE CANADIAN NURSERY TRADES ASSOCIATION.
3. BACKFILL WILL CONSIST OF SOIL NATIVE TO THE SITE OR GENERAL SOIL TYPE/CLASS NATIVE TO THE SITE. TOPSOIL TO BE TESTED FOR NUTRIENT VALUE, AND AMENDED FOR OPTIMAL GROWTH AS PER THE RECOMMENDATIONS OF THE SOIL TEST.
4. CONTRACTOR SHALL MAINTAIN ALL LANDSCAPE AREAS UNTIL OWNER'S ACCEPTANCE OF PROJECT.
5. CONTRACTOR TO LOCATE ALL UNDERGROUND UTILITIES.
6. PLANTING MAY BE ADJUSTED TO SUIT LOCATIONS OF SITE UTILITY STRUCTURES/SERVICES.
7. ALL MATERIALS MUST BE APPROVED BY LANDSCAPE ARCHITECT PRIOR TO INSTALLATION.
8. SPREAD MULCH TO A MINIMUM OF 100mm COMPACTED DEPTH ON ALL TREE PITS AND PLANTING BEDS.
9. CHECK AND VERIFY ALL DIMENSIONS AND QUANTITIES PRIOR TO COMMENCEMENT OF WORK. ANY DISCREPANCIES ARE TO BE REPORTED IN WRITING TO THE LANDSCAPE ARCHITECT. QUANTITIES NOTED WITHIN THE PLAN SUPERSEDE THOSE IN THE PLANT LIST. ANY SUBSTITUTIONS SHALL BE APPROVED BY THE LANDSCAPE ARCHITECT.
10. SOD AS MARKED WITH NURSERY SOD ON A MINIMUM OF 100mm OF CLEAN TOPSOIL. FINE GRADE AND SOD ALL BOULEVARD AREAS TO MUNICIPAL SPECIFICATIONS AND REPAIR DAMAGE TO ADJACENT PROPERTIES, AS REQUIRED.
11. FINAL INSPECTION AND ACCEPTANCE OF PLANTING WORK SHALL COINCIDE WITH THE FINAL INSPECTION AND ACCEPTANCE OF ALL WORK INCLUDED IN THE CONTRACT.
12. ALL SEEDED SLOPES 3:1 AND GREATER TO RECEIVE EROSION CONTROL MATTING. PIN SOD ON ALL SLOPES OF 3:1 OR GREATER.
13. SUBMIT A WRITTEN GUARANTEE TO THE EFFECT THAT ALL PLANTS ACCEPTED DURING THE PERIOD OF JANUARY 1st TO JULY 15th SHALL BE GUARANTEED UNTIL JULY 15th THE FOLLOWING YEAR. PLANTS ACCEPTED DURING THE PERIOD OF JULY 15th TO DECEMBER 31st SHALL BE GUARANTEED FOR ONE YEAR FROM THE DATE OF ACCEPTANCE. THE GUARANTEE PERIODS LISTED ABOVE SHALL APPLY TO ALL "NURSERY GROWN" PLANTS.
14. AT THE TIME OF FINAL INSPECTION ALL PLANTS SHALL BE IN A HEALTHY, VIGOROUS GROWING CONDITION, PLANTED IN FULL ACCORDANCE WITH DRAWINGS AND CONDITIONS.
15. EXISTING CONDITION INFORMATION AS PER HAMILTON-WENTWORTH DISTRICT SCHOOL BOARD.
16. TOPOGRAPHIC SURVEY AS PER MTE AND IS FOR INFORMATION ONLY.

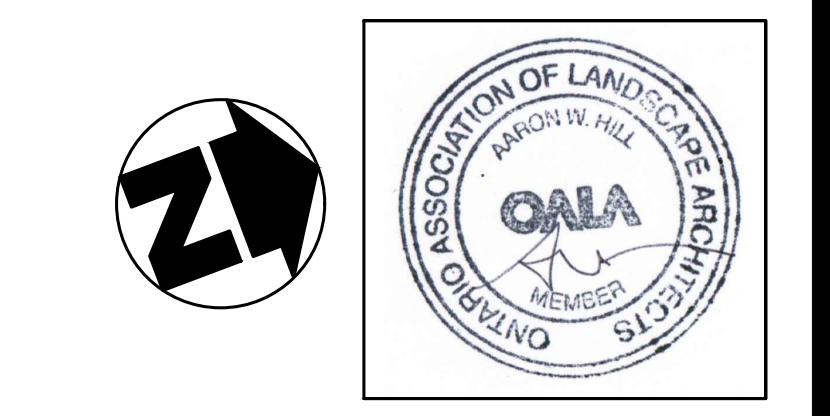

REVISIONS	no.	date	description	by
	1.	Mar 26 26	Issued for Tender	EH

Prince of Wales School
Elementary school
City of Hamilton
Grading and
Drainage Plan



PROJECT NO.: 2025-68	DRAWN BY: EH
SCALE: AS NOTED	DESIGNED BY: EH
SHEET:	APPROVED BY: AWH
L3	PLLOT DATE: Mar 26, 2026

CONCRETE BENCH BY ED'S CONCRETE (OR APPROVED EQUAL)
T 1-519-442-7900
WWW.EDSCONCRETE.CA
INFO@EDSCONCRETE.CA

SPECIFICATIONS:
SERIES: WATARI BENCH
MODEL: WA-STR
FINISH: SMOOTH
COLOUR: GREY STANDARD
INSTALLATION AS PER MANUFACTURERS INSTRUCTIONS

SECTION VIEW

PLAN VIEW

NOTES:

- CONTRACTOR TO REFER TO ARCHITECTURAL SPECIFICATIONS FOR COLOUR, FINISH AND ADDED VALUE FEATURES.
- SUBMIT COLOUR AND FINISH SAMPLES FOR APPROVAL.
- WEIGHT OF WATARI WA-STR BENCH - 15600g

EDS CONCRETE PRODUCTS	WATARI BENCH	
	WA-STR	
ED'S CONCRETE PRODUCTS 1266 ERE STREET STRATFORD, ONTARIO N4Z 0A1		
1-877-265-6590 www.edskoncrete.com info@edskoncrete.com		

CONCRETE CURVE BENCH BY ED'S CONCRETE (OR APPROVED EQUAL)
T 519-271-6590
F 612-331-2731
WWW.EDSCONCRETE.CA
INFO@EDSCONCRETE.COM

SPECIFICATIONS:
SERIES: WATARI BENCH
MODEL: WA-CUR
FINISH: SMOOTH
COLOUR: GREY STANDARD
INSTALLATION AS PER MANUFACTURERS INSTRUCTIONS

SECTION VIEW

PLAN VIEW

NOTES:

- CONTRACTOR TO REFER TO ARCHITECTURAL SPECIFICATIONS FOR COLOUR, FINISH AND ADDED VALUE FEATURES.
- SUBMIT COLOUR AND FINISH SAMPLES FOR APPROVAL.
- WEIGHT OF WATARI WA-CUR BENCH - 17500g

EDS CONCRETE PRODUCTS	WATARI BENCH	
	WA-CUR	
ED'S CONCRETE PRODUCTS 1266 ERE STREET STRATFORD, ONTARIO N4Z 0A1		
1-877-265-6590 www.edskoncrete.com info@edskoncrete.com		

SECTION

SECTIONAL ELEVATION

NOTES:

- ALL DIMENSIONS ARE IN MILLIMETERS. DO NOT SCALE DRAWING.
- ALL BOLTS, NAILS, SCREWS AND OTHER FASTENERS TO BE GALVANIZED. SIZE APPROPRIATELY AND COUNTERSINK AT SURFACE. FILL ALL SCREW HOLES WITH EXTERIOR GRADE WOOD FILLER.
- ALL WOOD TO BE EASTERN WHITE CEDAR, UNLESS SPECIFIED OTHERWISE, FREE FROM WARPS, CHECKS, CRACKS AND SPLINTERS
- WOOD FINISHES TO BE SPECIFIED BY SCHOOL. EITHER PROTECTIVE STAIN OR PAINT. CONFIRM COLOUR SELECTIONS AND FINISH PRIOR TO PURCHASING.
- ALL CUT EDGES AND EXPOSED CORNERS TO BE SANDED SMOOTH TO ELIMINATE SPLINTERS AND SHARP POINTS
- CHALK PANEL TO BE INSTALLED LEVEL AND SQUARE. ADJUST DIMENSIONS AS NEEDED BASED ON LAYOUT PLANS TO PROVIDE MINIMUM CLEARANCES
- CHALK PANEL CONSTRUCTION TO BE TO THE SATISFACTION OF THE LANDSCAPE ARCHITECT AND/OR OWNERS REPRESENTATIVE.

CHALK BOARD SUPPLIED BY NATURE'S INSTRUMENTS (1-877-733-7456) OR APPROVED EQUAL
MODEL NO. NI-PG-301-01
INSTALLED AS PER MANUFACTURER'S INSTRUCTIONS

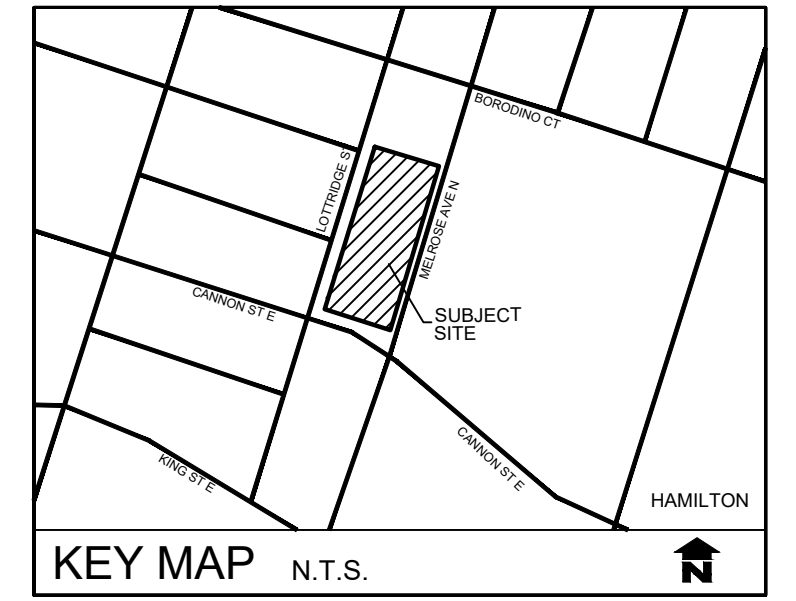

9 TYPICAL PRECAST CONCRETE SEAT WALL DETAIL
NTS

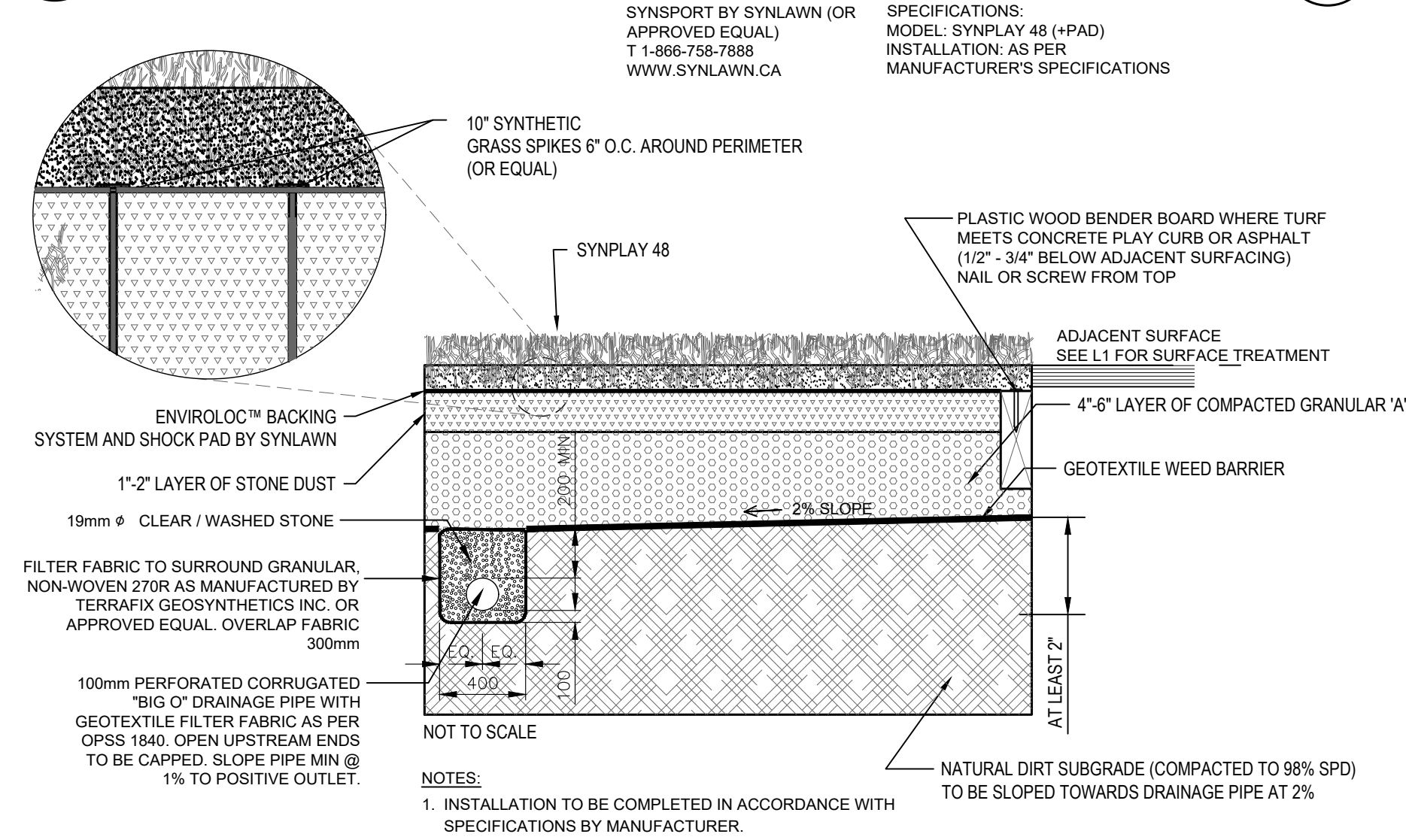

10 TYPICAL PRECAST CONCRETE CURVE SEAT WALL DETAIL
NTS

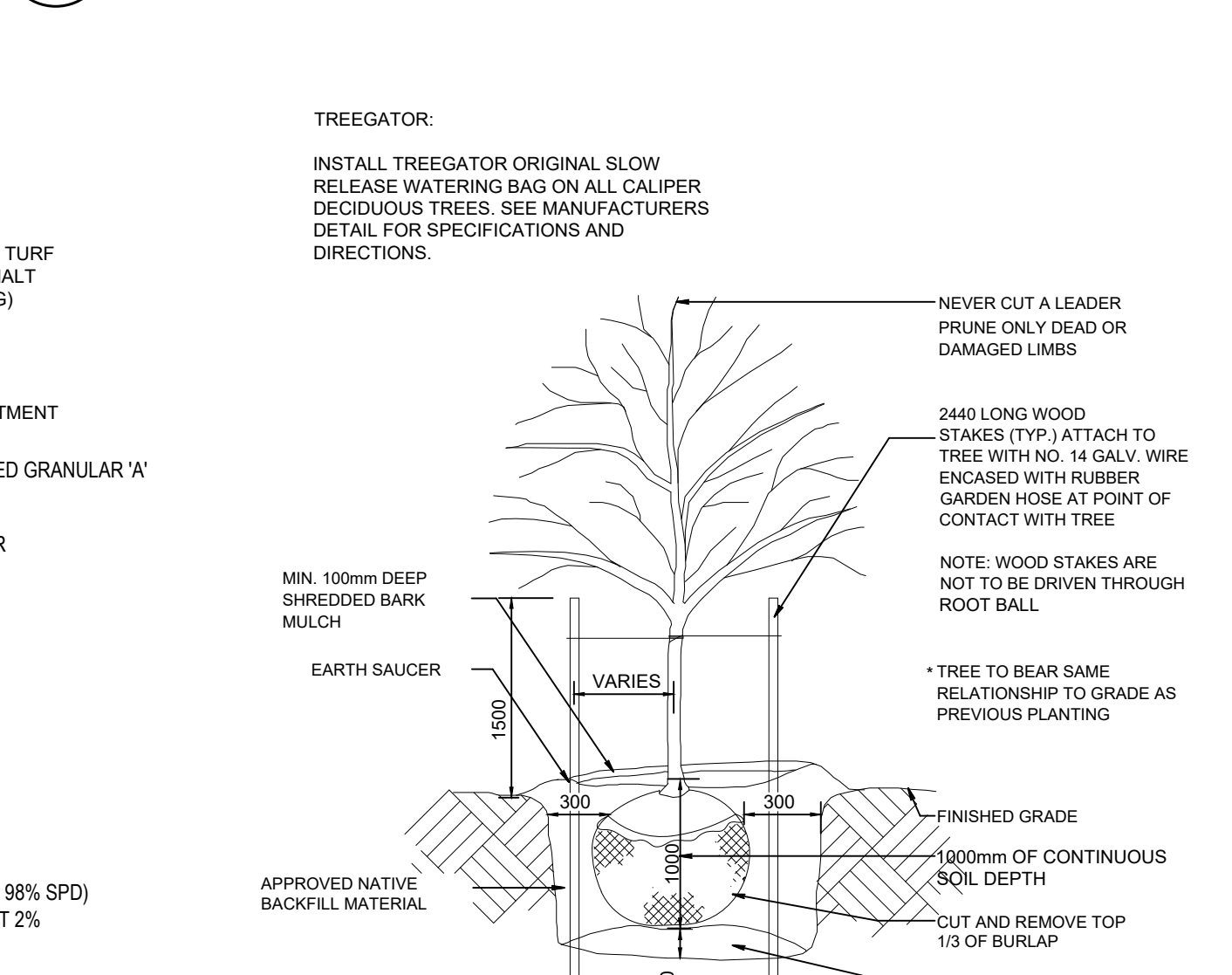

11 CHALK BOARD ON POSTS
NTS

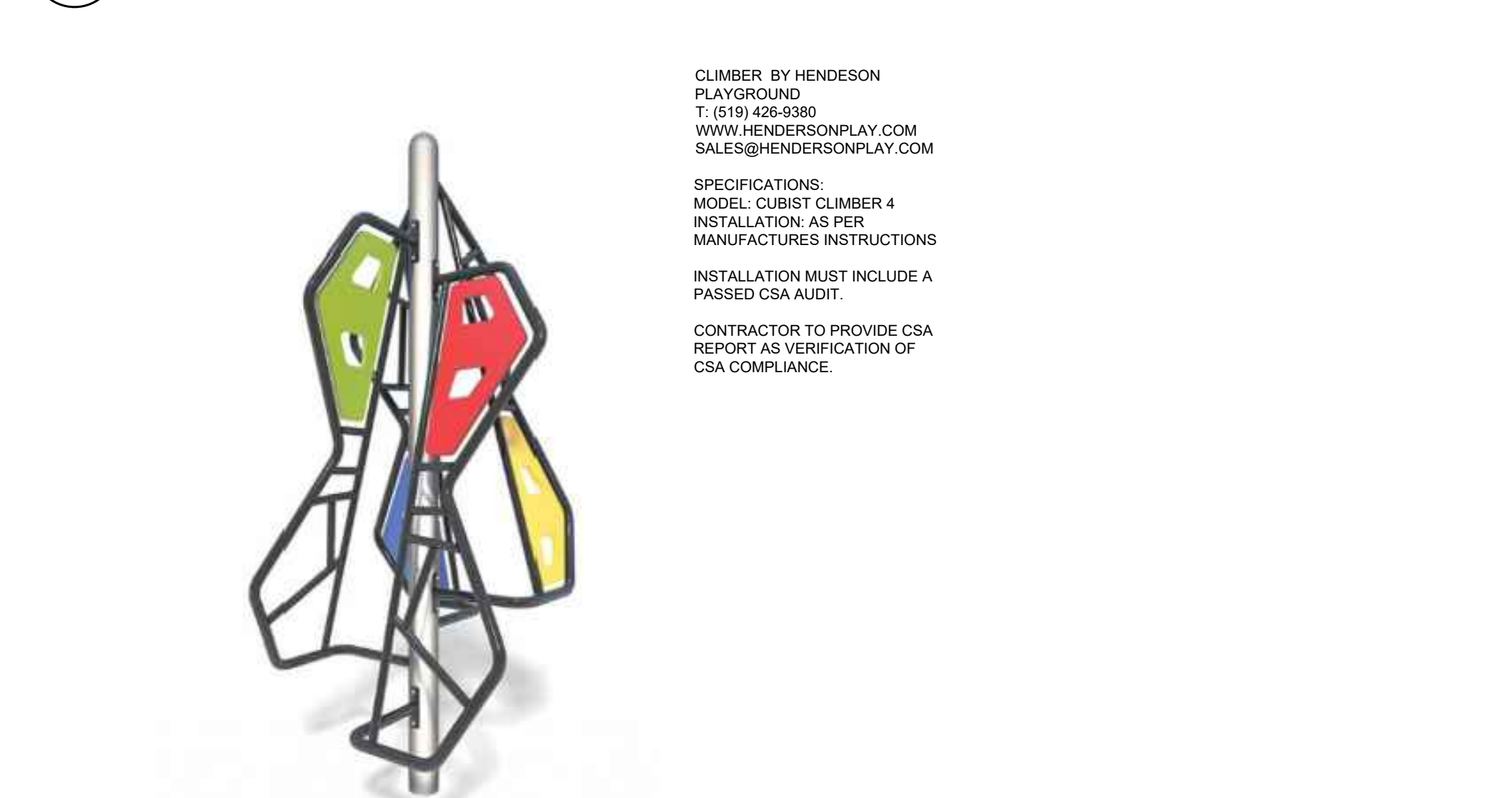

12 ARTIFICIAL TURF INSTALLATION DETAIL (FOR PLAY AREA ONLY)
NTS

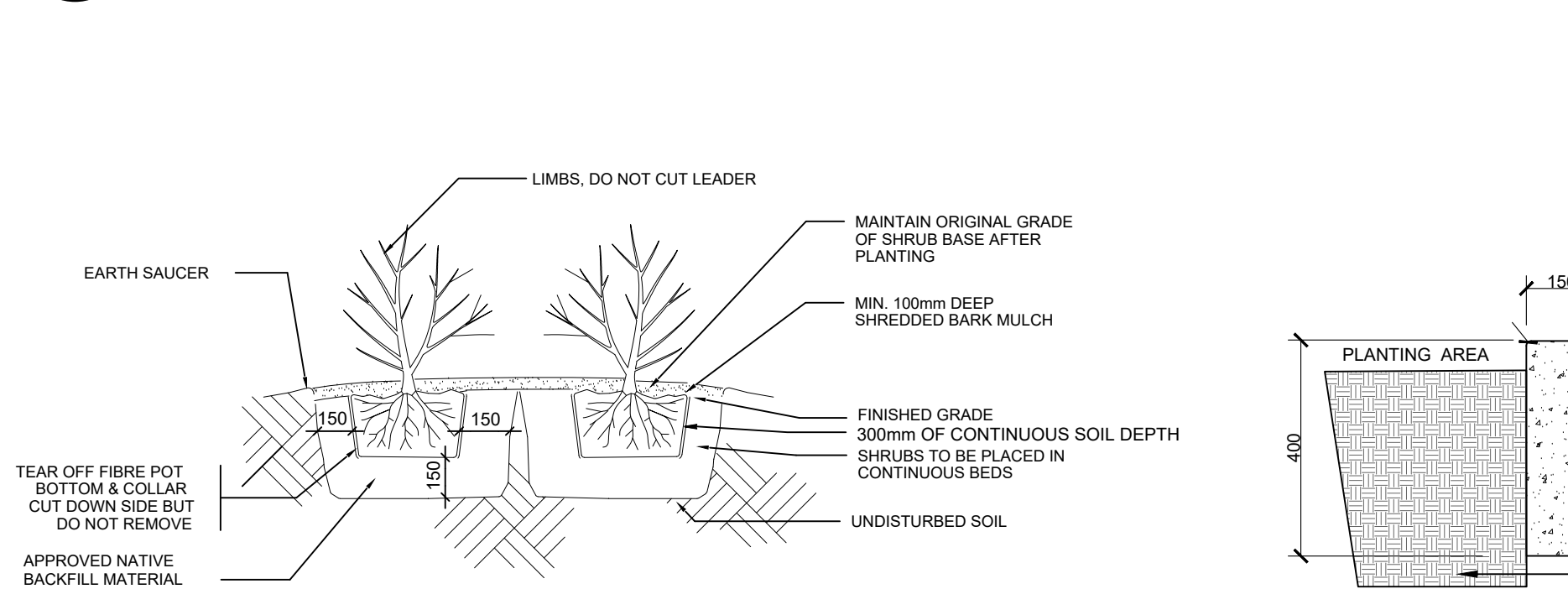

13 DECIDUOUS TREE PLANTING DETAIL
NTS

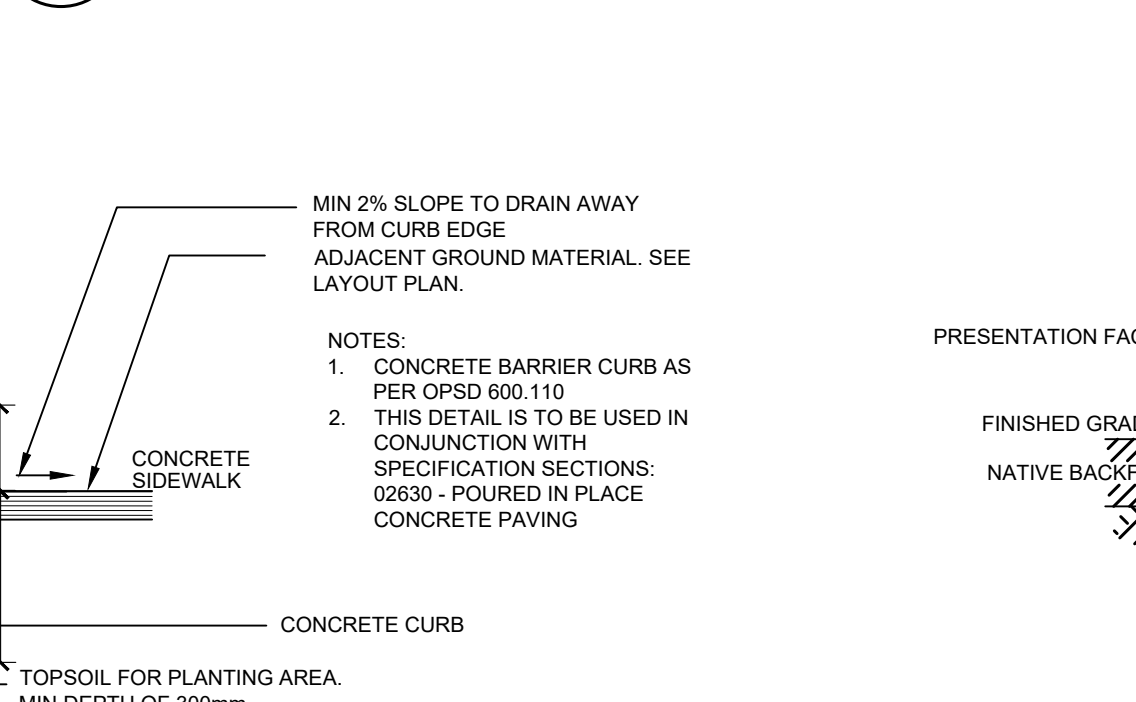

14 HENDERSON PLAYGROUND CUBIST CLIMBER 4
NTS

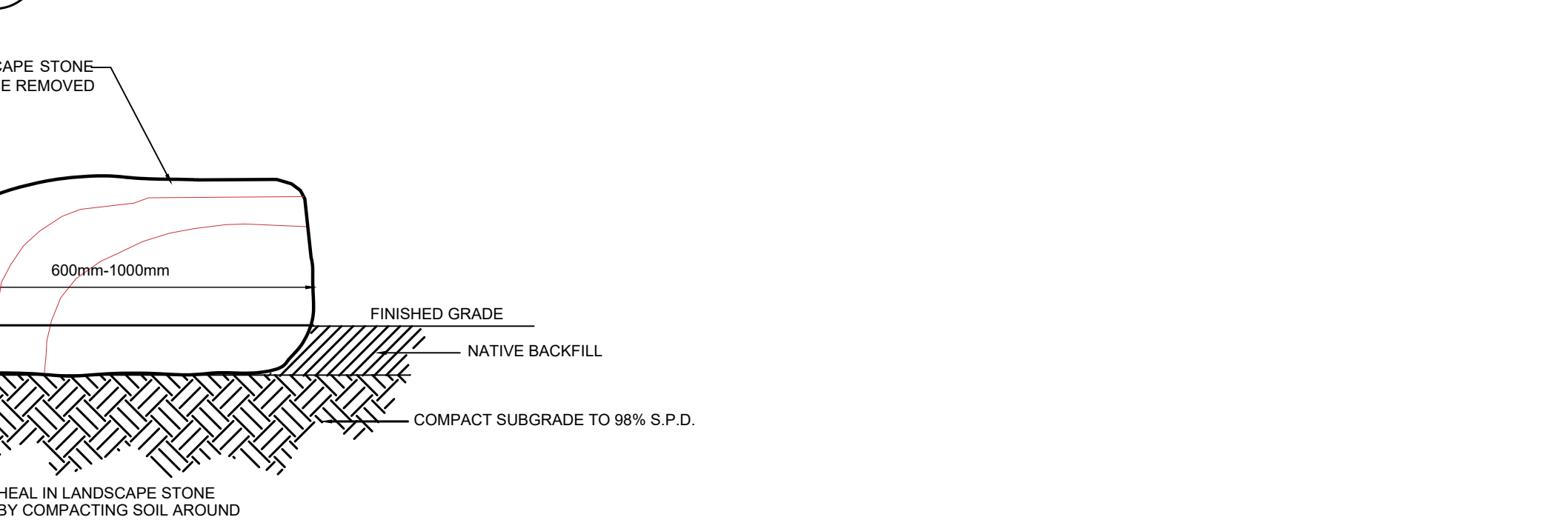

15 SHRUB PLANTING DETAIL
NTS



16 TYPICAL CONCRETE PLANTING CURB DETAIL
NTS



17 ARMOUR STONE DETAIL
NTS



REVISIONS

no.	date	description	by
1.	Mar 26 26	Issued for Tender	EH

Prince of Wales School
Elementary school
City of Hamilton

Landscape Details



PROJECT NO.: 2025-68
SCALE: AS NOTED
SHEET: L4

DRAWN BY: EH
DESIGNED BY: EH
APPROVED BY: AWH
PLOT DATE: Mar 26, 2025

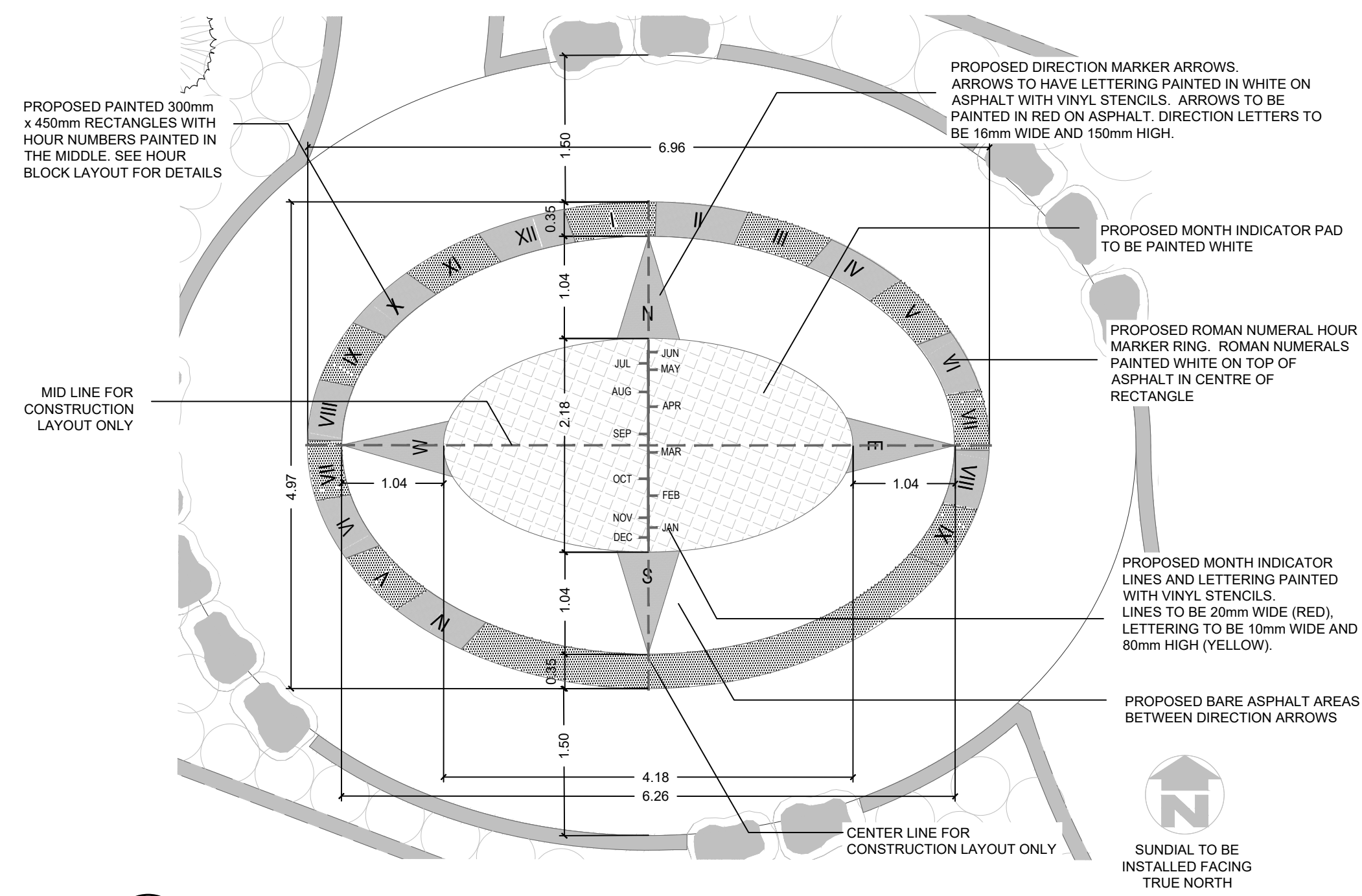

18 SUNDIAL DETAIL
1:50

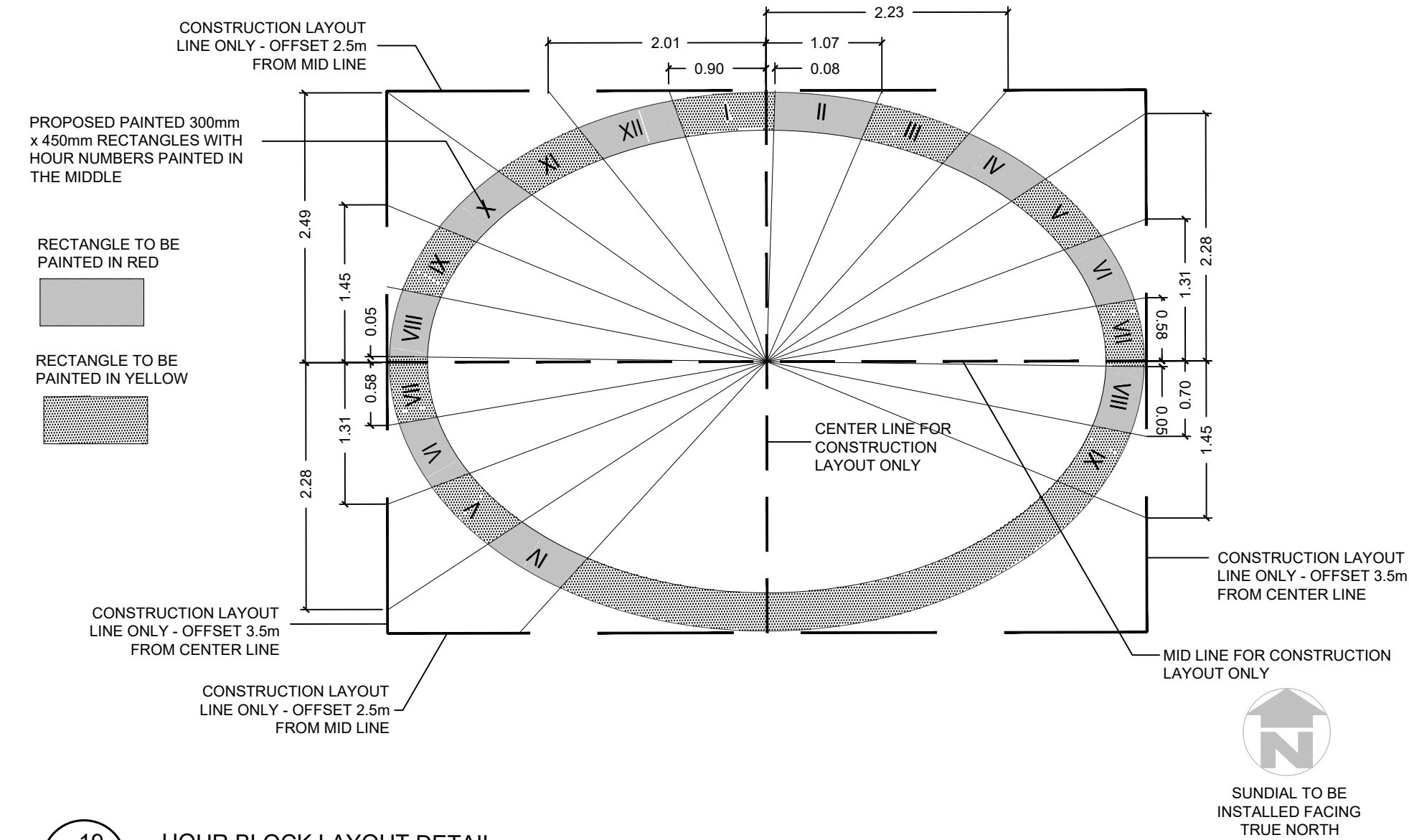

19 HOUR BLOCK LAYOUT DETAIL
1:50

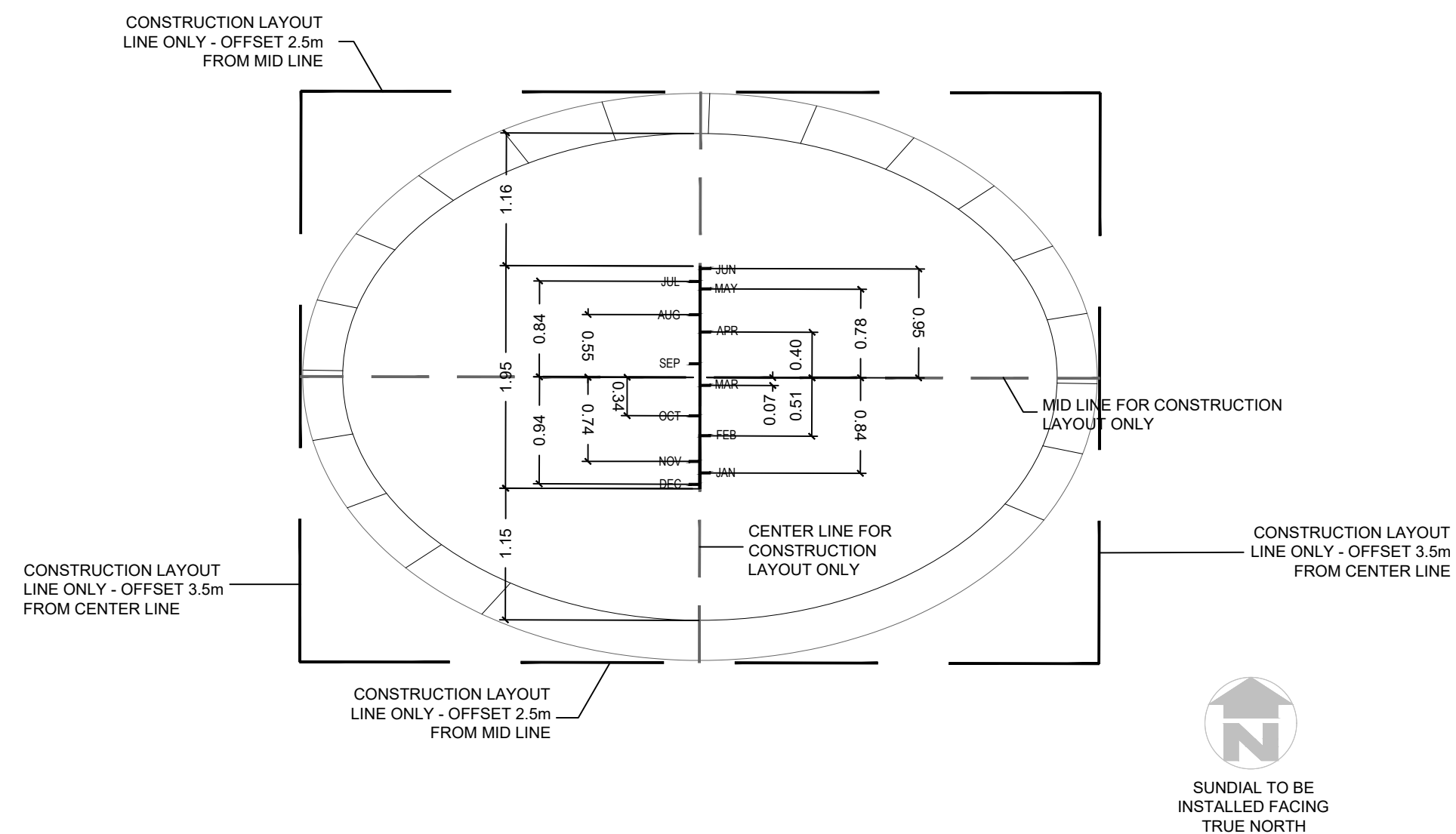

20 MONTH LAYOUT DETAIL
1:50

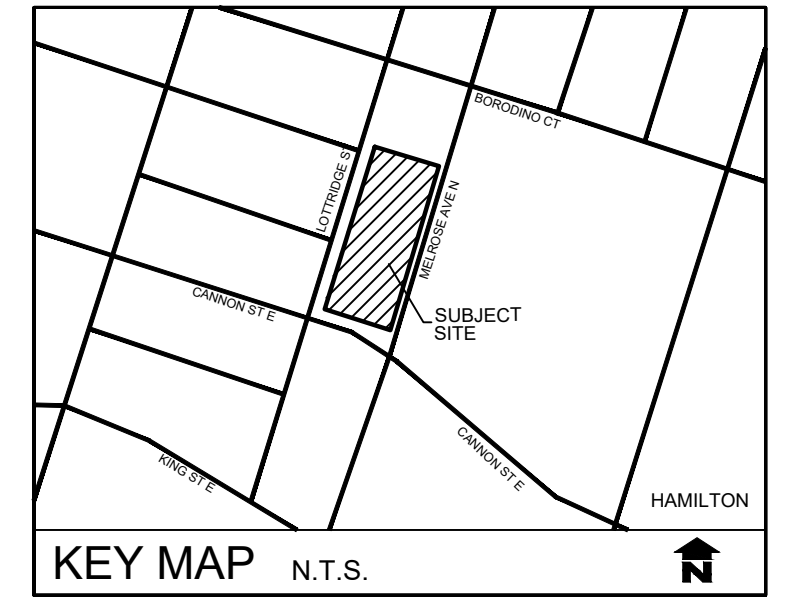

no.	date	description	by
1.	Mar 26 26	Issued for Tender	EH

Prince of Wales School
Elementary school
City of Hamilton

Landscape Details



PROJECT NO.: 2025-68	DRAWN BY: EH
SCALE: AS NOTED	DESIGNED BY: EH
SHEET: L5	APPROVED BY: AWH
	PLOT DATE: Mar 26, 2026